

Wheel Bearings Cups and Cones

FAA-PMA approved Timken wheel bearings for Goodyear, Cleveland, and McCauley wheels.

- Class 2 aviation grade bearings (Timken designates these with a -20629 suffix)
- When landing the wheel bearings must go from Zero RPM to 1384 RPM, or more, instantaneously. Automotive bearings aren't designed for this type of service
- Tighter tolerance and higher quality control than Class 4 automotive bearings
- Save \$\$



Don't be tempted to buy cheapy automotive bearings

Because Timken uses the same part number for both the automotive and aviation versions of these bearings, many people mistakenly use the lower quality automotive bearings in their airplane. It is critical that the FAA-PMA Class 2 version be used for aircraft applications for two reasons:

- They are a higher class of bearing with tighter tolerance and have been subjected to more stringent quality control procedures. Due to the smaller diameter of aircraft wheels, at a given ground speed the bearings rotate at a much higher RPM and require the tighter tolerances to prevent premature failure. Example: At a 70 mph touchdown speed (equivalent to highway speed of a car), a typical 17 inch diameter airplane tire is rotating at 1384 RPM, whereas a typical 27 inch car tire is only rotating at 871 RPM. So even though the aircraft bearing is only subject to intermittent use, some of the performance demands are much higher than a typical automotive application.
- It is a violation of FAA regulations to use non-approved automotive bearings on certified aircraft.

See the table on the next page to find the correct bearing for your wheels.

Wheel Grease Seal Kits

Finally a low cost alternative! FAA-PMA approved for Cessna aircraft with Cleveland, and McCauley wheels.

Convenient Kits now available

- Each kit contains everything required to service one wheel: grease seal rings, plates, snap rings and felts; even screws and washers when required.
- We have done the research so you don't have to!
- Hard to find parts in stock.
- Save \$\$



See the table on the next page to find the correct kit and components for your wheel.

Not sure what wheel you have?

Go to www.mcfarlaneaviation.com/wheel-seals to look up the original equipment wheels for your aircraft and for eligibility.

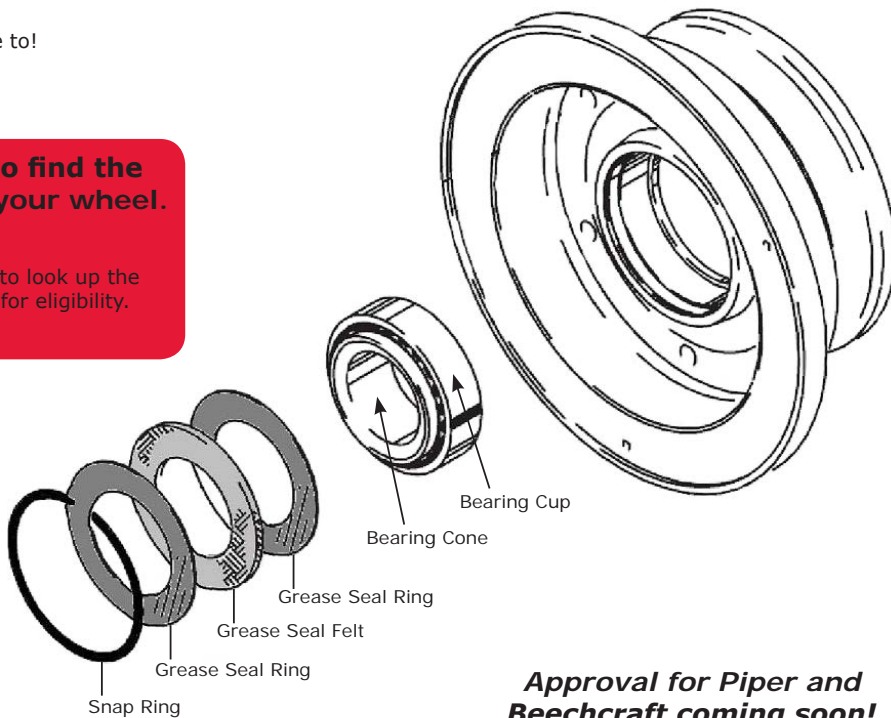

Approval for Piper and Beechcraft coming soon!

Hard to find grease seal rings and plates!

Figure A Flat Ring, Figure B Plate, Figure C Cupped Ring, Figure D Plate



Grease Seal Rings and Plates				
Part Number	ID	OD	Thickness	Figure
MC153-00300	1-33/64	2-1/2	0.034	A
MC153-00400	1-45/64	2-5/8	1/32	A
153-00500	1-3/4	2-3/4	5/32	B
MC153-00800	1-53/64	2-23/64	1/32	A
MC153-01000	2-1/16	2-3/4	1/8	B
MC153-01500	2-1/16	2-5/8	13/64	C
MC153-30013	1-11/16	2-39/64	1/32	A
153-30014	2-1/16	2-5/8	11/64	C
MC153-30015	1-17/32	2-35/64	1/32	A
MC156-00100	1-3/4	3/22-32	1/8	D

Grease Seal Felt			
Part Number	ID	OD	Thickness
154-01400	1-3/4	2-6	1/8
MC154-00300	1-5/8	2-5/8	1/8
MC154-00600	1-3/4	2-13/32	1/8
MC154-00900	2-1/8	2-7/16	1/8
MC154-01300	2-1/8	2-1/2	3/16
MC154-30010	2-1/8	2-17/32	1/8
Snap Ring			
MC155-00100	9/64	2-3/4	1/32
MC155-00200	9/64	2-1/2	0.025
MC155-11800	5/32	2-1/2	1/32
MC155-11900	5/32	2-3/4	1/32

Dimensions are approximate and for identification only. All dimensions are in inches.

Bearing Cups		
P/N	OD	Width
07196	1.9687	0.3750
07204	2.0470	0.5000
08231	2.3125	0.4219
13830	2.5000	0.3750
13836	2.5625	0.3750
18337	3.3750	0.5000
19268	2.6250	0.4688
39412	4.1250	0.6250
A4138	1.3775	0.3437
L217813	5.0000	0.7500
LL217810	4.7812	0.4375
LM29710	2.5625	0.5500
LM67010	2.3280	0.4650
LM501310	73.431	0.5800

Bearing Cones		
P/N	Bore	Inner Ring Width
07100	1.0000	0.5614
08118	1.1875	0.5937
08125	1.2500	0.5937
13889	1.5000	0.4688
18200	2.0000	0.7190
19150	1.5000	0.6504
39250	2.5000	0.8661
A4050	0.5000	0.4326
L217849	3.5000	0.5938
LL217849	3.5000	0.5938
LM29749	1.5000	0.7200
LM67048	1.2500	0.6600
LM501349	41.275	0.7800

Visit mcfarlaneaviation.com for aircraft eligibility



Brake and Wheel Parts

Wheel to Seal Kit and Bearing Cross Reference					
Wheel Manufacturer	Wheel Manufacturer P/N	Cessna Wheel P/N	Wheel Seal Kit P/N	Bearing Cone P/N	Bearing Cup P/N
CLEVELAND	040-07502	C163001-0301	WH-KT-2	13889	13836
CLEVELAND	40-101	C163001-0601	WH-KT-22	LM29749	LM29710
CLEVELAND	40-101A		WH-KT-22	LM29749	LM29710
CLEVELAND	40-113	C163001-0104	WH-KT-2	13889	13836
CLEVELAND	40-12	0441179-2	WH-KT-15	08125	08231
CLEVELAND	40-135A	9910393-2, 9910393-6	WH-KT-28	LM29749 and 07100	LM29710 and 07204
CLEVELAND	40-138A		WH-KT-17	LM29749 and 07100	LM29710 and 07204
CLEVELAND	40-140A	9910194-8	WH-KT-39	13889	13836
CLEVELAND	40-142	C163001-0701	WH-KT-2	13889	13836
CLEVELAND	40-177A	C163001-0901	WH-KT-42	13889	13836
CLEVELAND	40-179	040-17900	WH-KT-42	LM29749	LM29710
CLEVELAND	40-18	0441179-14	WH-KT-34	08125	08231
CLEVELAND	40-19	0441156-13	WH-KT-15	08125	08231
CLEVELAND	40-20	0441156-14	WH-KT-34	08125	08231
CLEVELAND	40-21	0441156-15	WH-KT-11	13889	13836
CLEVELAND	40-32	0741026-3	WH-KT-8	13889	13836
CLEVELAND	40-35	0743001-4	WH-KT-34	08125	08231
CLEVELAND	40-40A	5041016-3	WH-KT-28	LM29749 and 07100	LM29710 and 07196
CLEVELAND	40-40D	5041016-5	WH-KT-28	LM29749 and 07100	LM29710 and 07204
CLEVELAND	40-55	0441156-16	WH-KT-38	13889	13836
CLEVELAND	40-57	0441156-17	WH-KT-8	13889	13836
CLEVELAND	40-57A		WH-KT-11		
CLEVELAND	40-66	0441156-18	WH-KT-8	13889	13836
CLEVELAND	40-67	0441156-19	WH-KT-11	13889	13836
CLEVELAND	40-68	0441156-20	WH-KT-34	08125	08231
CLEVELAND	40-73	1241156-11	WH-KT-39	13889	13836
CLEVELAND	40-75	1241156-10	WH-KT-2	13889	13836
CLEVELAND	40-75B	040-07502, 1241156-10, C163001-0301	WH-KT-2	13889	13836
CLEVELAND	40-75D	C163001-0302	WH-KT-2	13889	13836
CLEVELAND	40-75T	040-07518-1	WH-KT-2	13889	13836
CLEVELAND	40-76	1241156-11	WH-KT-39	13889	13836
CLEVELAND	40-76A	1241156-11, 1241156-43	WH-KT-39	13889	13836
CLEVELAND	40-76B	0441156-16	WH-KT-42	13889	13836
CLEVELAND	40-77	1241156-12, 0441156-14, 0441156-20, 0441179-14, 0743001-4	WH-KT-34	08125	08231
CLEVELAND	40-78	1241156-13	WH-KT-34	08125	08231
CLEVELAND	40-79	1241156-14	WH-KT-2	13889	13836
CLEVELAND	40-79A	1241156-14	WH-KT-2	13889	13836
CLEVELAND	40-96E	C163001-0401	WH-KT-2	13889	13836
CLEVELAND	40-97	C163001-0102	WH-KT-2	13889	13836
CLEVELAND	40-97A	C163001-0102, C163001-0103	WH-KT-2	13889	13836
CLEVELAND	40-98A	C163001-0501	WH-KT-2	13889	13836
CLEVELAND	40-98H	C163001-0801	WH-KT-2	13889	13836
CLEVELAND	40-127, 40-137, 40-174			18200	18337
CLEVELAND	40-211, 40-279, 40-279A			39250	39412
GOODYEAR	9532522	0541183-9		13889	13830
GOODYEAR	9532673	0541160-13		13889	13830
GOODYEAR	511960S	0441016-1		13889	13830
GOODYEAR	95-3472	0441016-1		13889	13830
MCCAULEY	D30480	C163003-0401	WH-KT-35	LM67048	LM67010
MCCAULEY	D30065	C163002-0101		LM29749	LM29710
MCCAULEY	D30256	C163003-0101		LM29749	LM29710
MCCAULEY	D30291-1	C163004-0101	WH-KT-5	LM29749	LM29710
MCCAULEY	D30291-2	C163004-0102	WH-KT-5	LM29749	LM29710
MCCAULEY	D30291-3	C163004-0103	WH-KT-5	LM29749	LM29710
MCCAULEY	D30291-6	C163004-0104	WH-KT-5	LM29749	LM29710
MCCAULEY	D30500	C163002-0201, C163003-0201, C163005-0201	WH-KT-35	LM67048	LM67010
MCCAULEY	D30580	C163003-0102	WH-KT-5	LM29749	LM29710
MCCAULEY	D30660-1	C163002-0101, C163003-0101, C163005-0101, C163006-0101	WH-KT-5	LM29749	LM29710
MCCAULEY	D30660-2	C163006-0102	WH-KT-5	LM29749	LM29710
MCCAULEY	D30660-3	C163006-0103	WH-KT-5	LM29749	LM29710
MCCAULEY	D30665	9910194-1, C163002-0301, C163003-0301, C163003-0302, C163006-0201	WH-KT-47	LM29749	LM29710
		95-3472		13889	13830
		3244		A4050	A4138
		0441150-6, 0441150-7		LL217849	LL217810
GOODYEAR		0441150-8, 0441150-9, 0541116-2, 0541116-3		LL217849	LL217810

Note:
 For FAA-PMA approved aircraft model eligibility, see www.mcfarlaneaviation.com.
 ■ Cone P/N LM29749 and Cup P/N LM29710 are used on the outboard of the wheel and Cone P/N 07100 and Cup P/N 07196 or P/N 07204 are used on the inboard of the wheel.

Wheel Seal Kits			
Kit P/N	Qty	Part Number	Description
WH-KT-2	1	MC154-00300	Felt, Grease Seal
	1	MC154-01300	Felt, Grease Seal
	1	MC153-00300	Ring Grease Seal, Flat
	2	MC153-00400	Ring Grease Seal, Flat
	1	MC153-01500	Ring Grease Seal, Cupped
WH-KT-5	2	MC155-00100	Ring, Snap
	1	MC154-00300	Felt, Grease Seal
	1	MC154-30010	Felt, Grease Seal
	2	MC153-30013	Ring Grease Seal, Flat
	1	153-30014	Ring Grease Seal, Cupped
WH-KT-8	1	MC153-30015	Ring Grease Seal, Flat
	2	MC155-11900	Ring, Snap
	1	154-00400	Felt, Grease Seal
	1	153-00500	Plate, Grease Seal
	1	MC156-00100	Plate, Grease Seal
WH-KT-11	6	MS35265-45	Screw, Drilled
	6	MS35333-38	Lock Washer
	1	154-00400	Felt, Grease Seal
	1	MC154-00900	Felt, Grease Seal
	1	MC153-00300	Ring Grease Seal, Flat
WH-KT-15	1	153-00500	Plate, Grease Seal
	1	MC153-01000	Plate, Grease Seal
	1	MC156-00100	Plate, Grease Seal
	6	MS35265-45	Screw, Drilled
	6	MS35333-38	Lock Washer
WH-KT-17	1	MC154-00600	Felt, Grease Seal
	2	MC153-00800	Ring Grease Seal, Flat
	2	MC155-00200	Ring, Snap
	1	154-00800	Felt, Grease Seal
	2	153-00900	Ring Grease Seal, Flat
WH-KT-22	1	MC155-00100	Ring, Snap
	1	155-00600	Ring, Snap
	1	154-01400	Felt, Grease Seal
	2	153-00900	Ring Grease Seal, Flat
	2	MC155-00200	Ring, Snap
WH-KT-28	1	154-03000	Molded Seal
	1	MC155-00100	Ring, Snap
	1	155-00600	Ring, Snap
	2	MC154-00600	Felt, Grease Seal
	4	MC153-00800	Ring Grease Seal, Flat
WH-KT-34	2	MC155-00200	Ring, Snap
	2	MC154-00600	Felt, Grease Seal
	4	MC153-00800	Ring Grease Seal, Flat
	2	MC155-00200	Ring, Snap
	2	MC154-00600	Felt, Grease Seal
WH-KT-35	4	MC153-00800	Ring Grease Seal, Flat
	2	MC155-11800	Ring, Snap
	2	MC154-00900	Felt, Grease Seal
	2	MC153-00300	Grease Seal Plate
	2	MC153-01000	Plate, Grease Seal
WH-KT-38	6	MS35265-45	Screw, Drilled
	6	MS35333-38	Lock Washer
	2	MC154-01300	Felt, Grease Seal
	2	MC153-00300	Ring Grease Seal, Flat
	2	MC153-01500	Ring Grease Seal, Cupped
WH-KT-42	2	MC155-00100	Ring, Snap
	2	154-03000	Molded Seal
	2	MC155-00100	Ring, Snap
	2	MC154-30010	Felt, Grease Seal
	2	153-30014	Ring Grease Seal, Cupped
WH-KT-47	2	MC153-30015	Ring Grease Seal, Flat
	2	MC155-11900	Ring, Snap

Wheel Seal Kits and Components for Piper Aircraft Coming Soon!



APS BlackSteel® Brake Discs and Linings

Improved braking performance with superior rust pit resistance

APS is a leading manufacturer of FAA-PMA replacement brake components. Their proprietary **BlackSteel** brake discs and linings are designed to provide optimal braking performance and strength with longer service life.

Installation Tip:

One of the most important factors in disc and lining performance and safety margins is proper break-in.

For break-in procedures go to:

www.mcfarlaneaviation.com/pdfDocuments/APSBreak-InProcedures.pdf

APS BlackSteel® Brake Discs

State-of-the-art CNC machined from a one-piece forging

The high quality APS **BlackSteel** brake discs are CNC machined from one piece forgings, eliminating weld failures. When the metal is forged, it creates a directional grain flow that follows the contour of the disc. This allows for a much stronger disc that has a reduced risk of the cracking, distortion and catastrophic failures associated with inferior welded designs.

Proprietary heat treatment provides strength and corrosion resistance

BlackSteel discs are put through a proprietary heat treating process that strengthens the steel by bonding the carbon, oxygen, and nitrogen in the top layer of the metal. The process is not a coating, but a transformation of the top layer of the metal, providing corrosion resistance. The heat treatment gives the steel its black appearance and provides the surface with a high resistance to the corrosion and oxidation associated with the extreme thermal cycling experienced in aircraft braking systems. This makes it an excellent choice for agricultural aircraft that work in a harsh, chemical environment, as well as for anyone who leaves their aircraft outside most of the time.

The reduction of corrosion, pitting, rusting and longer service life result in enhanced safety, durability and value, while providing optimum braking performance and strength. APS discs can be used with APS lining or other PMA or OEM lining.



P/N APS164-02706



P/N APS164-00300



P/N APS164-03006

APS Brake Linings

Superior stopping power

Two types of brake linings are available: semi-metallic/organic (abrasive) and metallic (adherent).

The part number of the brake assembly as determined by the OEM dictates which type of lining is to be used.

APS linings can be used with APS discs or other PMA or OEM discs.

Semi-Metallic Brake Linings

The semi-metallic linings are made with Kevlar fibers integrated into the material, providing the greatest stopping power and long lining life. The optimal operating temperature of the semi-metallic linings is 600-900 deg F.

Metallic Brake Linings

APS metallic brake linings are constructed from an innovative design and durable materials, providing longer wear and superior stopping power for greater safety. The main ingredient in the metallic linings is iron. In an adherent system, a thin layer of lining material transfers and adheres to the disc during break-in. The optimal operating temperature range of the metallic linings is 950-1200 deg F.



P/N APS66-10900



P/N APS66-10800



P/N APS66-10600



P/N APS66-02200

Improved!



Top Lining
P/N APS66-04400
Bottom Lining



Improved in 2012 to Break-In Easier and Last Longer!

APS Lining Retaining Rivets and Pins

Lining retaining pins are used on various metallic brake linings and rivets are used on various organic brake linings. Retaining pins are sold individually and rivets are sold in packages of 25.

Rivets and Pins

Part Number	Description	Head Diameter	Shank Diameter
APS105-00200	Rivet	5/16"	5/32"
APS105-06700	Rivet	5/16"	3/16"
APS177-00300	Pin	5/16"	5/32"
APS177-00400	Pin	5/16"	3/16"
APS177-01600	Pin	3/8"	3/16"



P/N APS105-00200



P/N APS177-00300

See the following pages for use eligibility



FAA-PMA Approved

Brake Disc, Lining and Rivet Eligibility for Aircraft with Original Wheel and Brake Assemblies

Note: The wheel and brake assemblies on many aircraft have been changed. Verify the wheel and brake assembly part numbers on your aircraft to ensure proper selection. See the table on pages 164-165 for eligibility for aircraft with conversion kits installed.

Brake and Wheel Parts

Aircraft Model	Serial Number	Wheel Assy P/N	Brake Assy P/N	Brake Disc P/N	Lining P/N	Linings per Wheel	Rivet or Pin P/N
Aer Res							
J-2	All	40-78B	30-9	APS164-01700	APS66-10600	2	APS105-00200
Aerofab							
LA-250 (6-Place) Renegade	All	40-74B	30-51B	APS164-00700	APS66-10600	4	APS105-00200
LA-4	246 and up ²	40-113X	30-75X	APS164-04000	APS66-10500	2	APS105-00200
		40-74 or 40-74B	30-51 or 30-51B	APS164-00700	APS66-10600	4	APS105-00200
		40-74A	30-51	APS164-04700	APS66-10600	4	APS105-00200
Aerospatiale/Socata							
100,110,125,150,180 Series 110ST Calopin		40-97D	30-63J	APS164-02601	APS66-10500	2	APS105-00200
160ST Gamement, 180T Gairien, 180GT Gallaard	All	40-97D	30-63J	APS164-02601	APS66-10500	2	APS105-00200
220,236 Series, 235G Guerrier, 235GT Gabrier, 235CA Gaucho, TB20, 21 Trinidad	All	40-84	30-41B	APS164-01900	APS66-10600	4	APS105-00200
TB30 Epsilon	All	40-90B	30-23B	APS164-02201	APS66-06500	2	APS177-00300
TB9 Tampicp, TB10 Tobago, TB200	All	40-97E	30-63J	APS164-02601	APS66-10500	2	APS105-00200
Aero Commander							
112,112A	All	40-113A	30-79	APS164-04300	APS66-10500	2	APS105-00200
112B,112TC,112TCA,114, 114A,B	All	40-75H	30-52H	APS164-01501	APS66-10500	4	APS105-00200
Air Tractor							
AT-300,301,302	All	40-101	30-67X 30-89	APS164-03006	APS66-10800 APS66-10800	4 6	APS105-00200
AT-400	All	40-133	30-98C	APS164-05806	APS66-10800	12	APS105-00200
AT-400A	All	40-101	30-67X 30-89	APS164-03006	APS66-10800 APS66-10800	4 6	APS105-00200
AT-401,401A	All	40-234	30-184	APS164-05606	APS66-10800	8	APS105-00200
AT-402,501,502,503,503A	All	40-133	30-98C	APS164-05806	APS66-10800	12	APS105-00200
AT-602	All	40-403	30-231	APS164-22202	APS66-06600	12	APS177-00300
AT-802	All ²	40-279	30-210	APS164-23001	APS66-13100	16	APS105-06700
		40-279A	30-210A	APS164-23002	APS66-13100	16	APS105-06700
Aircraft Designs							
Stallion		40-75B	30-52	APS164-01501	APS66-10500	4	APS105-00200
American Champion							
7ACA	All ²	40-28D	30-19A	APS164-00500	APS66-10600	2	APS105-00200
7ECA, 7GCAA, 7GCBC, 7KCAB	All	40-78B	30-9	APS164-01700	APS66-10600	2	APS105-00200
8GCBC Scout	All	40-28D	30-19A	APS164-00500	APS66-10600	2	APS105-00200
8KCAB	All	40-47	30-32B	APS164-01100	APS66-10600	4	APS105-00200
T-250 Aries	All	40-28D	30-19A	APS164-00500	APS66-10600	2	APS105-00200
		40-75G	30-52S	APS164-01501	APS66-10500	4	APS105-00200
Arctic Aircraft							
S1B2 Arctic Tern	001 thru 1021 1022 and up	40-28 40-86B	30-18 30-55	APS164-00500 APS164-02000	APS66-10600 APS66-10500	2 2	APS105-00200
ASTA GAF (Nomad)							
N22B, N22S	All	40-75T	30-52Q	APS164-08300	APS66-10500	4	APS105-00200
N24A	All ²	40-75T 40-143	30-52Q 30-129	APS164-08300 APS164-08200	APS66-10500 APS66-06200	4 4	APS105-00200 APS177-00300
Avions Pierre Robin							
140, 160	All	40-97D	30-52T	APS164-03601	APS66-10500	4	APS105-00200
DR400 Series	All	40-97D	30-63E	APS164-02601	APS66-10500	2	APS105-00200
HR100	All ²	40-97D	30-63D or 30-63E	APS164-02601	APS66-10500	2	APS105-00200
HR120	All	40-97D	30-52N	APS164-03601	APS66-10500	4	APS105-00200
HR200	All ²	40-97D	30-63D or 30-63E	APS164-02601	APS66-10500	2	APS105-00200
HR210	All	40-97D	30-52N	APS164-03601	APS66-10500	4	APS105-00200
HR400 Series	All	40-97D	30-52T	N/A	APS66-10500	4	APS105-00200
R1000, R2000, R3000 Series	All	40-97D	30-63E	N/A	APS66-10500	2	APS105-00200
R2160	All	40-97A	30-63E	APS164-02601	APS66-10500	2	APS105-00200
Ayres							
S2R-PZL600 Thrush	R35-001 and up	40-133	30-98D	APS164-05806	APS66-10800	12	APS105-00200
S2R-600 Thrush	1939 thru 2529R	40-129	30-94	APS164-05606	APS66-10800	8	APS105-00200
	2530R and up	40-133	30-98D	APS164-05806	APS66-10800	12	APS105-00200
S2R-711 Turbo Thrush	T11-001 and up	40-133	30-98D	APS164-05806	APS66-10800	12	APS105-00200
S2R-800 Thrush	5000R thru 5082R	40-129	30-94	APS164-05806	APS66-10800	8	APS105-00200
	5083R and up	40-133	30-98	APS164-05806	APS66-10800	12	APS105-00200
S2RHG-T65 Turbo Thrush	All	40-133	30-98D	APS164-05806	APS66-10800	12	APS105-00200
S2R-R1340, S2R-R1820, S2R-R3S	All	40-133	30-98D	APS164-05806	APS66-10800	12	APS105-00200
S2R-T15 Turbo Thrush	All	40-133	30-98	APS164-05806	APS66-10800	12	APS105-00200
S2R-T34 Turbo Thrush	6000 and up	40-133	30-98D	APS164-05806	APS66-10800	12	APS105-00200
S2R-T41 Turbo Thrush	T41-089 and 090	40-133	30-98D	APS164-05806	APS66-10800	12	APS105-00200
S2R-T65 Turbo Thrush	All	40-133	30-98D	APS164-05806	APS66-10800	12	APS105-00200
Beechcraft							
M19A, B19 ¹	MB-461 thru MB-865						
A23, A23A, A23-19, A23-24	All	40-113C	30-75B or 30-79A	APS164-04300	APS66-10500	2	APS105-00200
B23, C23 ¹	M-1095 thru M-1979						
A24R, B24R, C24R ¹	MC-22 thru MC-536						
33, A33	All	40-1	30-1	APS164-00900	APS66-11100	2	APS105-00200
B33 ¹	CD-388 thru CD-639	40-37	30-24	APS164-00700	APS66-10600	4	APS105-00200
F33A ¹	CE-301 thru CE-634 CE635 thru CE-1071	40-83	30-54	APS164-02505	APS66-10500	4	APS105-00200
		40-83A	30-54C	APS164-02505	APS66-10500	4	APS105-00200
F33C ¹	CJ-125 thru CJ-155	40-83A	30-54C	APS164-02505	APS66-10500	4	APS105-00200
G33 ¹	CD-1272 thru CD-1304	40-83	30-54	APS164-02504	APS66-10500	4	APS105-00200
V35B ¹	D-9862 thru D-10403	40-83	30-54A	APS164-02504	APS66-10500	4	APS105-00200
36, A36 ¹	E-1 thru E-824	40-83	30-54	APS164-02505	APS66-10500	4	APS105-00200
A36 ¹	E-825 thru E-3635	40-83A	30-54,54A,or 54C	APS164-02505	APS66-10500	4	APS105-00200

¹ Partial model eligibility
² Must verify wheel or brake assembly P/N

Eligibility continued on next page.



Brake and Wheel Parts Brake Discs and Linings

Continued from previous page

Aircraft Model	Serial Number	Wheel Assy P/N	Brake Assy P/N	Brake Disc P/N	Lining P/N	Linings per Wheel	Rivet or Pin P/N
A36TC, B36TC	EA-1 thru EA-695	40-83A or 40-83B	30-54A or 30-54C	APS164-02505	APS66-10500	4	APS105-00200
B55	All	40-128D	30-93B	APS164-06106	APS66-09700	6	APS177-00300
	TC-2092 thru TC-2180	40-128	30-93B	APS164-06106	APS66-04400	6	APS177-00300
	TC-2181 thru TC-2456	40-98G	30-66G	APS164-02706	APS66-09700	4	APS177-00300
C55, D55	All	40-98	30-66	APS164-02706	APS66-04400	4	APS177-00300
	All	40-128D	30-93C	APS164-06106	APS66-09700	6	APS177-00300
E55	TE-768 thru TE-1142	40-98	30-66	APS164-02706	APS66-04400	4	APS177-00300
	TE-1143 thru TE-1201	40-98	30-66	APS164-02706	APS66-04400	4	APS177-00300
		40-98G	30-66G	APS164-09700	APS66-09700	4	APS177-00300
56TC, A56TC	All	40-98	30-69A	APS164-02706	APS66-02200	4	APS177-00300
58	All	40-128D	30-93C	APS164-06106	APS66-09700	6	APS177-00300
	TH-1 thru TH-972	40-98	30-66	APS164-02706	APS66-04400	4	APS177-00300
	TH-973 thru TH-2124	40-98	30-66	APS164-02706	APS66-04400	4	APS177-00300
		40-98G	30-66G	APS164-02706	APS66-09700	4	APS177-00300
58P1	TJ-436 thru TJ-497	40-171	30-145	APS164-20806	APS66-09700	6	APS177-00300
B60	All	40-171	30-145	APS164-20806	APS66-09700	6	APS177-00300
76	All	40-83	30-54B	APS164-02504	APS66-10500	4	APS105-00200
Bellanca							
17-30A, 17-31A, 17-31ATC	All	40-75E	30-52M	APS164-01501	APS66-10500	4	APS105-00200
DW-1	All	40-101	30-89A	APS164-03006	APS66-10800	6	APS105-00200
Burkhart Grob							
G103, G103C Twin II Sailplane	All	40-97A	30-63A	APS164-02601	APS66-10500	2	APS105-00200
G109 Series Power Glider	All	40-78B	30-9	APS164-01700	APS66-10600	2	APS105-00200
Cessna							
120, 140, 140A	All	40-97A	30-63A	APS164-02601	APS66-10500	2	APS105-00200
150A, B	15059119 thru 15059700	40-12	30-9	APS164-00400	APS66-10600	2	APS105-00200
150C	All	40-57	30-40	APS164-00400	APS66-10600	2	APS105-00200
150D,E	All	40-79A	30-40	APS164-01600	APS66-10600	2	APS105-00200
150F,G	All	40-97	30-63	APS164-02601	APS66-10500	2	APS105-00200
150H,J,K	All	40-97A	30-63A	APS164-02601	APS66-10500	2	APS105-00200
150L, M	15072004 thru 15074850	D-30063	C-30018	N/A	APS66-10900	2	APS105-00200
	15074851 thru 15077403	40-113	30-75	APS164-04000	APS66-10500	2	APS105-00200
	15077380, 15077402, 15077404 thru 15079113	40-113	30-75	APS164-04000	APS66-10500	2	APS105-00200
		D30291-6	C30018 or C30018-4	APS164-30440	APS66-10900	2	APS105-00200
		40-97A	30-63A	APS164-02601	APS66-10500	2	APS105-00200
A150K	All	40-97A	30-63A	APS164-02601	APS66-10500	2	APS105-00200
A150L, M	A1500227 thru A1500429	D-30063	C-30018	N/A	APS66-10900	2	APS105-00200
		40-113	30-75	APS164-04000	APS66-10500	2	APS105-00200
	A1500430 thru A15000641	40-113	30-75	APS164-04000	APS66-10500	2	APS105-00200
A150M	A15000642 thru A1500717	40-113	30-75	APS164-04000	APS66-10500	2	APS105-00200
		D30291-6	C30018 or C30018-4	APS164-30440	APS66-10900	2	APS105-00200
F150F,G	All	40-97	30-63	APS164-02601	APS66-10500	2	APS105-00200
F150H,J	All	40-97A	30-63A	APS164-02601	APS66-10500	2	APS105-00200
F150K,L,M	F1500530 thru F15001332	40-113	30-75	APS164-04000	APS66-10500	2	APS105-00200
F150M	F15001333 thru F15001418	40-113	30-75	APS164-04000	APS66-10500	2	APS105-00200
		D30291-6	C30018-4	APS164-30440	APS66-10900	2	APS105-00200
FA150K,L	All	40-113	30-75	APS164-04000	APS66-10500	2	APS105-00200
FRA150L	All	40-113	30-75	APS164-04000	APS66-10500	2	APS105-00200
152	All	40-113	30-75	APS164-04000	APS66-10500	2	APS105-00200
		D30063	C-30018	N/A	APS66-10900	2	APS105-00200
A152, F152	All	40-113	30-75	APS164-04000	APS66-10500	2	APS105-00200
FA152		40-113	30-75	APS164-04000	APS66-10500	2	APS105-00200
		D-30660-1	C-30018-5	APS164-30615-4	APS66-10900	2	APS105-00200
		D-30600-1	C-30018-5	N/A	APS66-10900	2	APS105-00200
		D-30580	C-30018-4	APS164-30195	APS66-10900	2	APS105-00200
		D-30291-6	C-30018-4	APS164-30440	APS66-10900	2	APS105-00200
172, 172A,B,C	17246421 thru 17249544	40-113	30-75	APS164-04000	APS66-10900	2	APS105-00200
172D,E,F,G,H,I,K	All	40-97A	30-56, 30-63, 30-63A	APS164-02601	APS66-10500	2	APS105-00200
172L,M	17259224 thru 17263458	40-97A	30-56, 30-63,	APS164-02601	APS66-10500	2	APS105-00200
		D-30063	C-30018-2	N/A	APS66-10900	2	APS105-00200
		40-113	30-63A, 30-75A	APS164-04000	APS66-10500	2	APS105-00200
172M,N,P,Q,R,S	17263459 and on	40-113	30-75A	APS164-04000	APS66-10500	2	APS105-00200
172RG	All	D-30660-1	C-30018-6, C-30764-5	APS164-30615-4	APS66-10900	2	APS105-00200
F172F,G,H	All	40-97A	30-56, 30-63A	APS164-02601	APS66-10500	2	APS105-00200
F172K	All	40-113	30-75A	APS164-04000	APS66-10500	2	APS105-00200
F172L	F17200805 thru F17200904	40-113	30-75A	APS164-04000	APS66-10500	2	APS105-00200
F172M	F17200905 thru F17201514	40-113	30-75A	APS164-04000	APS66-10500	2	APS105-00200
		D-30260, D30580	C-30018-2	APS164-30195	APS66-10900	2	APS105-00200
F172N	F17201515 thru F17201639	D-30600-1	C-30018-6	N/A	APS66-10900	2	APS105-00200
		40-113	30-75A	APS164-04000	APS66-10500	2	APS105-00200
F172N,P	F17201640 thru F17202254	D-30660-1	C-30018-6, C30764-6	APS164-30615-4	APS66-10900	2	APS105-00200
		40-113	30-75A	APS164-04000	APS66-10500	2	APS105-00200
F172RG	All	40-113	30-75	APS164-04000	APS66-10500	2	APS105-00200
FR172J	FR17200351 thru FR17200590	D-30260	C-30018-2	APS164-30195	APS66-10900	2	APS105-00200
FR172K	FR17200591 thru FR17200620	D-30600-1	C-30018-6	N/A	APS66-10900	2	APS105-00200
	FR17200621 thru FR17200675	D-30660-1	C-30018-6, C30764-6	APS164-30615-4	APS66-10900	2	APS105-00200
R172H	R1720453 thru R1720603	D-30063	C-30018-2	N/A	APS66-10900	2	APS105-00200
175, A,B	17555876 thru 17557119	40-97A	30-63A	APS164-02601	APS66-10500	2	APS105-00200
177A,B	17701165 thru 17701530	40-97A	30-63A	APS164-02601	APS66-10500	2	APS105-00200
177B	17701531 thru 17702123	40-113	30-45	APS164-04000	APS66-10500	2	APS105-00200
177B	17702124 thru 17702313	40-113	30-45	APS164-04000	APS66-10500	2	APS105-00200
		D-30580	C-30018-4	APS164-30195	APS66-10900	2	APS105-00200
	17702314 thru 17702522	40-113	30-45	APS164-04000	APS66-10500	2	APS105-00200
		D-30291-6	C-30018-4	APS164-30440	APS66-10900	2	APS105-00200
	17702523 thru 17702672	40-113	30-45	APS164-04000	APS66-10500	2	APS105-00200
	D-30660-1	C-30018-5	N/A	APS66-10900	2	APS105-00200	
	17702673 thru 17702752	40-113	30-45	APS164-04000	APS66-10500	2	APS105-00200
		D-30660-1	N/A	APS164-30615-4	APS66-10900	2	APS105-00200

1 Partial model eligibility
2 Must verify wheel or brake assembly P/N

Eligibility continued on next page.

Brake and Wheel Parts



Aircraft Model	Serial Number	Wheel Assy P/N	Brake Assy P/N	Brake Disc P/N	Lining P/N	Linings per Wheel	Rivet or Pin P/N
Cessna 177RG	177RG0001 thru 177RG0592	40-113	30-75	APS164-04000	APS66-10500	2	APS105-00200
	177RG0593 thru 177RG0782	40-113	30-75	APS164-04000	APS66-10500	2	APS105-00200
		D-30580	C-30018-4	APS164-30195	APS66-10900	2	APS105-00200
	177RG0788 thru 177RG1051	40-113	30-75	APS164-04000	APS66-10500	2	APS105-00200
		D-30291-6	C-30018-4	APS164-30440	APS66-10900	2	APS105-00200
	177RG1052 thru 177RG1266	40-113	30-75	APS164-04000	APS66-10500	2	APS105-00200
D-30660-1		C-30018-5	N/A	APS66-10900	2	APS105-00200	
177RG1267 thru 177RG1366	40-113	30-75	APS164-04000	APS66-10500	2	APS105-00200	
	D-30660-1	N/A	APS164-30615-4	APS66-10900	2	APS105-00200	
	F177RG0001 thru F177RG0122	40-113	30-75	APS164-04000	APS66-10500	2	APS105-00200
		40-113	30-75	APS164-04000	APS66-10500	2	APS105-00200
F177RG0123 thru F177RG0138	D-30580	C-30018-4	APS164-30195	APS66-10900	2	APS105-00200	
	40-113	30-75	APS164-04000	APS66-10500	2	APS105-00200	
F177RG0139 thru F177RG0160	D-30291-6	C-30018-4	APS164-30440	APS66-10900	2	APS105-00200	
	40-113	30-75	APS164-04000	APS66-10500	2	APS105-00200	
	D-30660-1	C-30018-5	N/A	APS66-10900	2	APS105-00200	
F177RG0161 thru F177RG0177	40-113	30-75	APS164-04000	APS66-10500	2	APS105-00200	
	D-30660-1	C-30018-5	N/A	APS66-10900	2	APS105-00200	
180G	All	40-75B	30-52	APS164-01501	APS66-10500	4	APS105-00200
180H	18051775 thru 18051993	40-66	30-21	APS164-00700	APS66-10600	4	APS105-00200
	18052011 thru 18052284	40-75D	30-52D, 30-52N	APS164-03601	APS66-10500	4	APS105-00200
180J	18052285 thru 18052500	D-30063-1	C-30018-1	N/A	APS66-10900	2	APS105-00200
		D30291-3	C30118-4	APS164-30414	APS66-10900	2	APS105-00200
		40-75B	30-52D	APS164-01501	APS66-10500	2	APS105-00200
		40-75D	30-52N	APS164-03601	APS66-10500	2	APS105-00200
180J, K	18052501 thru 18052924	40-75B	30-52D	APS164-01501	APS66-10500	2	APS105-00200
		40-75D	30-52N	APS164-03601	APS66-10500	2	APS105-00200
		D30291-3	C30118-4	APS164-30414	APS66-10900	2	APS105-00200
180K	18052925 thru 18053203	40-75B	30-52D	APS164-01501	APS66-10500	2	APS105-00200
		40-75D	30-52N	APS164-03601	APS66-10500	2	APS105-00200
182B, C, D, E, F, G, H, J, K, L, M, N	18251886 thru 18260445	D30660-2	C30118-5	APS164-30615-2	APS66-10900	2	APS105-00200
		40-97A	30-63A, 30-56A	APS164-02601	APS66-10500	2	APS105-00200
182N	18260446 thru 18260825	40-113	30-75	APS164-04000	APS66-10500	2	APS105-00200
		40-113	30-75	APS164-04000	APS66-10500	2	APS105-00200
182P	18260826 thru 18264295	40-113	30-75	APS164-04000	APS66-10500	2	APS105-00200
		D-30291-6	C-30018-4	APS164-30440	APS66-10900	2	APS105-00200
		40-113	30-75	APS164-04000	APS66-10500	2	APS105-00200
182Q	18264296 thru 18265175	D-30291-6	C-30018-4	APS164-30440	APS66-10900	2	APS105-00200
		40-113	30-75	APS164-04000	APS66-10500	2	APS105-00200
	18265176 thru 18265328	D-30600-1	C-30018-5	N/A	APS66-10900	2	APS105-00200
		40-113	30-75	APS164-04000	APS66-10500	2	APS105-00200
	18265329 thru 18265965	D-30600-1	C-30018-5	N/A	APS66-10900	2	APS105-00200
D30660-1		C-30018-5	APS164-30615-4	APS66-10900	2	APS105-00200	
18265966 thru 18267715	40-113	30-75	APS164-04000	APS66-10500	2	APS105-00200	
	D-30600-1	C-30018-5	APS164-30615-4	APS66-10900	2	APS105-00200	
182R	18267716 thru 18268541	D30660-3	D30118-4	APS164-30615-3	APS66-10900	2	APS105-00200
182S, T, T182T	All	40-75B	30-52E	APS164-01501	APS66-10500	4	APS105-00200
F182P	All	D-30291-6	C-30018-4	APS164-30440	APS66-10900	2	APS105-00200
F182Q	F18200026 thru F18200064	D-30600-1	C-30018-5	N/A	APS66-10900	2	APS105-00200
F182Q	F18200065 thru F18200169	D-30600-1	C-30018-5	APS164-30615-4	APS66-10900	2	APS105-00200
FR182, R182, TR182, T182	All	D-30660-3	D-30118-3	APS164-30615-3	APS66-10900	4	APS105-00200
185, 185A	All	40-32	30-21	APS164-00700	APS66-10600	4	APS105-00200
185B	All	40-66	30-21	APS164-00700	APS66-10600	4	APS105-00200
185C, D, E	185-0654 thru 185-1149	40-75B	30-52	APS164-01501	APS66-10500	4	APS105-00200
A185E	185-1150 thru 18502090	40-66	30-21	APS164-00700	APS66-10600	4	APS105-00200
		40-75B	30-52	APS164-01501	APS66-10500	4	APS105-00200
		40-75D	30-52D	APS164-03601	APS66-10500	4	APS105-00200
A185F	All	40-75B	30-52	APS164-01501	APS66-10500	4	APS105-00200
		40-75D	30-52D	APS164-03601	APS66-10500	4	APS105-00200
		D-30291-3	D-30118-5	APS164-30414	APS66-10900	4	APS105-00200
		D-30291-1	D-30118-5	APS164-30388	APS66-10900	4	APS105-00200
		D-30660-2	D-30118-5	APS164-30615-2	APS66-10900	4	APS105-00200
188, 188A, 188B, A188, A188A	188-0001 thru 18801040	40-75B	30-52B	APS164-01501	APS66-10500	4	APS105-00200
A188B, T188C	18801041 thru 18803521 18801041T thru T18803521	40-101A	30-67	APS164-03106	APS66-10800	4	APS105-00200
		40-101	30-67A	APS164-03006	APS66-10800	4	APS105-00200
		40-101A	30-67A	APS164-03106	APS66-10800	4	APS105-00200
		40-98A	30-66A	APS164-02707	APS66-11000	4	APS105-00200
210-5 (205)	All	40-67	30-35	APS164-00700	APS66-10600	4	APS105-00200
210-5A (205A)	All	40-75B	30-52	APS164-01501	APS66-10500	4	APS105-00200
206, U206, A, B, C, D	206-0001 thru U206-1256	40-75B	30-52	APS164-01501	APS66-10500	4	APS105-00200
U206D, E	U2061257 thru U20601700	40-75B	30-52	APS164-01501	APS66-10500	4	APS105-00200
		40-75D	30-52N	APS164-03601	APS66-10500	4	APS105-00200
U206F	U20601701 thru U20602199	40-75B	30-52	APS164-01501	APS66-10500	4	APS105-00200
		40-75D	30-52N	APS164-03601	APS66-10500	4	APS105-00200
U206F, G	U20602200 thru U20604649	D-30291-1	D-30118-6	APS164-30388	APS66-10900	4	APS105-00200
		40-75D	30-52N	APS164-03601	APS66-10500	4	APS105-00200
	U20604650 thru U20607020	D-30291-1	D-30118-6	APS164-30388	APS66-10900	4	APS105-00200
		D-30660-2	D-30118-6	APS164-30615-2	APS66-10900	4	APS105-00200
	40-75D	30-52N	APS164-03601	APS66-10500	4	APS105-00200	
D-30660-2	D-30118-6	APS164-30615-2	APS66-10900	4	APS105-00200		
D-30660-3	D-30118-4	APS164-30615-3	APS66-10900	4	APS105-00200		
206H, T206H	All	40-75B	30-52U	APS164-01501	APS66-10500	4	APS105-00200
P206, P206A, B, C, D	P206-0001 thru P206-0566	40-75B	30-52	APS164-01501	APS66-10500	4	APS105-00200
P206D, E	P206-0557 thru P20600647	40-75D	30-52N	APS164-03601	APS66-10500	4	APS105-00200
207, 207A, T207, T207A	All	40-75B	30-52F	APS164-01501	APS66-10500	4	APS105-00200
		40-75D	30-52A	APS164-03601	APS66-10500	4	APS105-00200
208, 208A, B	All	40-179	30-163 or 30-182	APS164-22201	APS66-03300 APS66-15300	8	APS177-00300

1 Partial model eligibility

2 Must verify wheel or brake assembly P/N

3 Aircraft with 30-182A calipers installed must use APS66-15300 linings. Aircraft with 30-182 calipers installed may use either APS66-03300 or APS66-15300 linings in complete sets. **Caution:** Never mix APS66-03300 linings on the same caliper as the APS66-15300's. APS66-15300 linings are .035" thicker than the APS66-03300's.

4 Complete Brake Kit P/N 208-BRK-KT-1 contains: brake discs, brake linings, pins, bleeder seat, bleeder needle, needle cap and O-ring.

Eligibility continued on next page.



Brake and Wheel Parts Brake Discs and Linings



FAA-PMA Approved

Continued from previous page

Aircraft Model	Serial Number	Wheel Assy P/N	Brake Assy P/N	Brake Disc P/N	Lining P/N	Linings per Wheel	Rivet or Pin P/N
Cessna							
210C	21058086 thru 21058220	40-21	30-45	APS164-00900	APS66-11100	2	APS105-00200
210D,E,F,G,H,J,K,L ¹	21058221 thru 21060089 ²	40-75B D-30291-2	30-52 or 30-52V D-30118-4	APS164-01501 APS164-30398	APS66-10500 APS66-10900	4	APS105-00200 APS105-00200
210L ¹ ,M,N,R	21060090 thru 21065009 ²	40-75B D-30291-2 D-30660-3	30-52 or 30-52V D-30118-4 D-30118-4	APS164-01501 APS164-30398 APS164-30615-3	APS66-10500 APS66-10900 APS66-10900	4	APS105-00200 APS105-00200 APS105-00200
P210N,R	All ²	40-75B 40-142	30-52V 30-127C	APS164-01501 APS164-07800	APS66-10500 APS66-06200	4	APS105-00200 APS177-00300
T210F,G,H,J	All	40-75 or 40-75B	30-52	APS164-01501	APS66-10500	4	APS105-00200
303, T303	All ²	40-142 40-98H	30-127C 30-66F	APS164-07800 APS164-08406	APS66-06200 APS66-04400	4	APS177-00300 APS177-00300
305	All ²	40-75F 40-97E	30-52L 30-63K	APS164-01501 APS164-02601	APS66-10500 APS66-10500	4	APS105-00200 APS105-00200
310R ¹	310R0501 thru 310R2140 ²	40-40A 40-40D	30-28B 30-28B	APS164-00806 APS164-20206	APS66-03300 APS66-03300	6	APS177-00400 APS177-00400
335	All	40-40A	30-28B	APS164-00806	APS66-03300	6	APS177-00400
336	3360001 thru 3360098 3360099 and up	40-67 40-75B	30-35 30-52	APS164-00700 APS164-01501	APS66-10600 APS66-10600	4	APS105-00200 APS105-00200
337, 337A	All	40-96A	30-61	APS164-02504	APS66-10500	4	APS105-00200
337B ¹ ,C,D	3370526 thru 337-0619 3370526 thru 3371193	40-96A 40-96A	31-61A 31-61D	APS164-02504 APS164-02504	66-03600 ³ APS66-10500	4	APS105-00200 APS105-00200
337E	All	40-98A	30-69B	APS164-02707	APS66-02200	4	APS177-00300
340, 340A ¹	340-0001 thru 340A1200	40-40A	30-28B	APS164-00806	APS66-03300	6	APS177-00400
340A ¹	340A1201 thru 340A1817	40-40D	30-28B	APS164-20206	APS66-03300	6	APS177-00400
401 Series	All	40-40A	30-28B	APS164-00806	APS66-03300	6	APS177-00400
402,A,B ¹	4020001 thru 402C0400	40-135	30-100	APS164-06406	APS66-06600	8	APS177-01600
402B,C ¹	402C0401 thru 402C1020 ²	40-135 40-135A	30-100 30-100	APS164-06406 APS164-20306	APS66-06600 APS66-06600	8	APS177-01600 APS177-01600
404	All	40-132	30-97	APS164-09100	APS66-06400	8	APS177-01600
411, 411A ¹	All ²	40-40A	30-28B	APS164-00806	APS66-03300	6	APS177-00400
414	All	McCauley	N/A	N/A	APS66-06600		APS177-01600
414A ¹	414A0001 thru 414A0600 ²	40-135	30-100	APS164-06406	APS66-06600	8	APS177-01600
		40-40A	30-28B	APS164-00806	APS66-03300	6	APS177-00400
		40-135	30-100	APS164-06406	APS66-06600	8	APS177-01600
		40-40A	30-28B	APS164-00806	APS66-03300	6	APS177-00400
421C ¹	421C0001 thru 421C0910 421C1001 thru 421C1807	40-135	30-100	APS164-06406	APS66-06600	8	APS177-01600
		40-135A	30-100	APS164-20306	APS66-06600	8	APS177-01600
425	All	40-138 or 40-138A	30-113 or 30-113A	APS164-05500	APS66-06400	8	APS177-01600
Cirrus Design Group							
SR-20	1601 and up	40-75P	30-52AB	APS164-01501	APS66-10500	4	APS105-00200
SR-22	1740 and up	40-406	30-233B	APS164-02504	APS66-06200	4	APS177-00300
Daimler Benz/ M.B.B.							
B.O. 209 Monsun	All	40-78B	30-9	APS164-01700	APS66-10600	2	APS105-00200
Diamond Aircraft							
DA20	All	40-78E	30-9D	APS164-24200	APS66-10600	2	APS105-00200
DA40	All	40-14A	30-239	APS164-24400	APS66-14100	2	APS105-00200
DA42 Twin Star	All	40-75Z	30-52Z	APS164-01501	APS66-10500	4	APS105-00200
Eagle Aircraft							
220, 300 Eagle	All	40-101	30-89A	APS164-03006	APS66-10800	6	APS105-00200
Explorer Aeronautique							
Private Explorer Float	All	40-101	30-67B	APS164-03006	APS66-10800	4	APS105-00200
FFA Flugzeugwerke							
AS202-18A4 Bravo	All	40-97A	30-63A	APS164-02601	APS66-10500	2	APS105-00200
Found Brothers							
100 Centennial	All	40-75B	30-52	APS164-01501	APS66-10500	4	APS105-00200
GAF Australia							
N22B, N22S	All	40-75T	30-52Q	APS164-08300	APS66-10500	4	APS105-00200
N24A	All ²	40-75T 40-143	30-52Q 30-129	APS164-08300 164-08200 ⁴	APS66-10500 APS66-06200	4	APS105-00200 APS177-00300
General Aviation (Italy)							
F.20 Pegaso, F.20TP condor	All	40-75G	30-52P	APS164-01501	APS66-10500	4	APS105-00200
F.22 Pinguino	All	40-151	30-164	APS164-08500	APS66-06200	2	APS177-00300
Great Lakes							
2T-1A	All	40-113	30-75	APS164-04000	APS66-10500	2	APS105-00200
Grob							
G103, G103C	All	40-97A	30-63A	APS164-02601	APS66-10500	2	APS105-00200
G109, G109B	All	40-78B	30-9	APS164-01700	APS66-10600	2	APS105-00200
Grumman							
AA-1, AA-5	All	40-86A	30-55B	APS164-02000	APS66-10500	2	APS105-00200
AA-1A, AA-1B, AA-5A, AA-5B	All	40-88C	30-56B	APS164-02000	APS66-10500	2	APS105-00200
700	All	40-128C	30-93A	APS164-05006	APS66-02200	6	APS177-00300
450, 600	All	40-101	30-67	APS164-03006	APS66-10800	4	APS105-00200
G164	All	40-47	30-32C	APS164-01100	APS66-10600	4	APS105-00200
G164A	All	40-101	30-67	APS164-03006	APS66-10800	4	APS105-00200
G164B, G164C, G164D	All	40-133	30-84	APS164-05806	APS66-10800	8	APS105-00200
GA-7	All	40-90	30-23B	APS164-02201	APS66-06500	2	APS177-00300
Helio							
H-250, H-295, H-391, H-395	All ²	40-75D	30-52N	APS164-03601	APS66-10500	4	APS105-00200
		40-75E	30-52A	APS164-01501	APS66-10500	4	APS105-00200
		40-75T	30-52N	APS164-08300	APS66-10500	4	APS105-00200
		40-98A	30-66A	APS164-02707	APS66-10500	4	APS105-00200
Hunting Firecracker A/C							
NDN1T Turbo Firecracker	All	40-120C	30-83A	N/A	APS66-06200	4	APS177-00300
Industria Unidas SA							
A-9B Sparrow, Quail	All	40-99	30-41	APS164-02800	APS66-10600	4	APS105-00200

¹ Partial model eligibility
² Must verify wheel or brake assembly P/N
³ OEM lining must be used
⁴ OEM disc must be used

Eligibility continued on next page.

Brake and Wheel Parts



FAA-PMA Approved

Continued from previous page

Aircraft Model	Serial Number	Wheel Assy P/N	Brake Assy P/N	Brake Disc P/N	Lining P/N	Linings per Wheel	Rivet or Pin P/N
Marsh Aviation							
G-164C-T Turbo Cat	All	40-133	30-84	APS164-05806	APS66-10800	8	APS105-00200
S2R-T Turbo Thrush	All ²	40-129 or 40-133	30-94	APS164-05606	APS66-10800	8	APS105-00200
Maule Air							
M4, M5, M6 Series	All	40-97D	30-63E	APS164-02601	APS66-10500	2	APS105-00200
M7, M9 Series	All	40-75D	30-52A or 30-52N	APS164-03601	APS66-10500	4	APS105-00200
Mcculloch							
J-2 Helicopter	All	40-78B	30-9	APS164-01700	APS66-10600	2	APS105-00200
Mooney							
M10 Cadet	All ²	40-97 or 40-97A	30-63 or 30-63A	APS164-02601	APS66-10500	2	APS105-00200
M20A, B ¹	1401 thru 3466	40-24	30-5	APS164-00900	APS66-11100	N/A	APS105-00200
M20C ¹	670001 thru 690098	40-86	30-56A	APS164-02000	APS66-10500	2	APS105-00200
M20D	All	40-24	30-5	APS164-00900	APS66-11100	N/A	APS105-00200
M20E ¹	101 thru 1308	40-24	30-5	APS164-00900	APS66-11100	N/A	APS105-00200
M20F ¹	670001 thru 700061	40-86	30-56A	APS164-02000	APS66-10500	2	APS105-00200
M20F ¹	660003 thru 700072	40-86	30-56A	APS164-02000	APS66-10500	2	APS105-00200
M20G, J, K	All	40-86	30-56A	APS164-02000	APS66-10500	2	APS105-00200
M20M	All	40-92A	30-65	APS164-02300	APS66-10500	4	APS105-00200
NDN Aircraft							
NDN6 Fieldmaster	All	40-175	30-149	164-21100 ⁴	APS66-06600	12	APS177-01600
Pacific Aerospace							
FU24-954; FU24A-954	240, 247 and up	40-47	30-32C	APS164-01100	APS66-10600	4	APS105-00200
08-600 Cresco	All	40-101	30-89	APS164-03006	APS66-10800	6	APS105-00200
Partenavia							
P.64B, P.66B	All	40-28	30-18	APS164-00500	APS66-10600	2	APS105-00200
P.66C-160, P.66T	All	40-86B	30-55	APS164-02000	APS66-10500	2	APS105-00200
P.68, P.68B, P.68C, P.68C-TC	All	40-142	30-127	APS164-07800	APS66-06200	4	APS177-00300
Partenavia							
Series 300	All	40-163	30-139	APS164-20500	APS66-06200	8	APS177-00300
Performance Aircraft							
Legend	All	40-96E	30-61E	APS164-02504	APS66-10500	4	APS105-00200
Pilatus Britten-Norman							
BN-2 Series	All ²	40-90F 40-90 40-90B 40-98F	30-23D 30-23A 30-23C 30-66D	APS164-01506 APS164-02201 APS164-02201 APS164-02706	APS66-06500 APS66-06500 APS66-06500 APS66-02200	2 2 2 4	APS177-00300 APS177-00300 APS177-00300 APS177-00300
Pilatus Britten-Norman							
Defender 4000	All	40-128E	30-93E	164-23300 ⁴	APS66-04400	6	APS177-00300
Piper							
J-3, PA-11, PA-12, PA-14, PA-16	All	40-60	30-60	APS164-06700	APS66-10600	4	APS105-00200
PA-18	All ²	40-60 40-84	30-60 30-41	APS164-06700 APS164-01900	APS66-10600 APS66-10600	4 4	APS105-00200 APS105-00200
PA-18-150, PA-18A-150	All	40-60	30-60	APS164-06700	APS66-10600	4	APS105-00200
PA-20	All ²	40-60 40-84	30-60 30-41	APS164-06700 APS164-01900	APS66-10600 APS66-10600	4 4	APS105-00200 APS105-00200
PA-22	All	40-84	30-41	APS164-01900	APS66-10600	4	APS105-00200
PA-22-108	All	40-28	30-18	APS164-00500	APS66-10600	2	APS105-00200
PA-23-150, 160	All	40-3	30-13	159-00200 ⁴	APS66-10600	4	APS105-00200
PA-23-235	All	40-4	30-8	APS164-00206	APS66-10600	8	APS105-00200
PA-E23-250 ¹	27-3738 thru 27-7554 and 27-7554139	40-116	30-72	APS164-03206	APS66-06500	4	APS177-00300
	27-7554141 thru 27-7554149 and 27-7554138	40-116 or 40-131	30-96	APS164-05700	APS66-06200	8	APS177-00300
PA-24-180,250,260 ¹	24-1 thru 24-3306	40-5	30-12	159-00100 ⁴	APS66-10600	4	APS105-00200
	24-3307 and On ²	40-58 40-84	30-41 30-41B	APS164-00900 APS164-01900	APS66-10600 APS66-10600	4 4	APS105-00200 APS105-00200
PA-25, PA-25-235	25-1 thru 25-1999 25-2000 thru 25-4171 25-4172 and on	40-5 40-61 40-84A	30-12 30-41 30-41B	159-00100 ⁴ APS164-01300 APS164-03300	APS66-10600 APS66-10600 APS66-10600	4 4 4	APS105-00200 APS105-00200 APS105-00200
PA-28-140	28-20002 thru 28-20520 28-20521 thru 28-7725290	40-28 40-86	30-18 30-55	APS164-00500 APS164-02000	APS66-10600 APS66-10500	2 2	APS105-00200 APS105-00200
PA-28-150	28-1 thru 28-1760	40-28	30-18	APS164-00500	APS66-10600	2	APS105-00200
PA-28-151	All	40-86B	30-55	APS164-02000	APS66-10500	2	APS105-00200
PA-28-160	28-1761 thru 28-4377	40-86	30-55	APS164-02000	APS66-10500	2	APS105-00200
PA-28-161	All	40-86B	30-55	APS164-02000	APS66-10500	2	APS105-00200
PA-28-180 ¹	28-1 thru 28-1760 28-1761 thru 28-5869 28-7105001 thru 28-7505260	40-28 40-86 40-86	30-18 30-55 30-55	APS164-00500 APS164-02000 APS164-02000	APS66-10600 APS66-10500 APS66-10500	2 2 2	APS105-00200 APS105-00200 APS105-00200
PA-28R-180	All ²	40-84 40-86	30-41 30-55	APS164-01900 APS164-02000	APS66-10600 APS66-10500	4 2	APS105-00200 APS105-00200
PA-28-181	All	40-86B	30-55	APS164-02000	APS66-10500	2	APS105-00200
PA-28R-200 ¹	28R-35001 thru 28R-7135109 28R-7135110 thru 28R-7635545	40-84 40-86 or 40-86B	30-41 30-55	APS164-01900 APS164-02000	APS66-10600 APS66-10500	4 2	APS105-00200 APS105-00200
PA-28-201T, PA-28R-201	All	40-86B	30-55	APS164-02000	APS66-10500	2	APS105-00200
PA-28R-201T, PA-28RT-201	All	40-86B	30-55	APS164-02000	APS66-10500	2	APS105-00200
PA-28-235	28-7410001 thru 28-7710089	40-86	30-55	APS164-02000	APS66-10500	2	APS105-00200
PA-28-236	All ²	40-86B 40-90A	30-55 30-65	APS164-02000 APS164-02300	APS66-10500 APS66-10500	2 4	APS105-00200 APS105-00200
PA-30	30-2 - 30-845 30-846 thru 30-2000	40-34 40-90	30-23 30-23	APS164-01000 APS164-02201	APS66-06500 ³ APS66-06200 ³	2 2	APS177-00300
PA-31-300,310 ¹	31-5 thru 31-7300962	40-102	30-68	APS164-03506	APS66-03300	6	APS177-00400
PA-31-325	All	40-102A	30-68A	APS164-04406	APS66-03300	6	APS177-00400
PA-31-350 ¹	31-5001 thru 31-8452021	40-102A 40-130	30-68A 30-95A	APS164-04406 APS164-07906	APS66-03300 APS66-06600	6 8	APS177-00400 APS177-01600
PA-31-350 ¹ (T-1020)	Heavy Duty Option	40-141	30-123	APS164-07700	APS66-06800	12	APS177-01600
	31-8253001 thru 31-8453021	40-130	30-95A	APS164-07906	APS66-06600	8	APS177-01600
PA-31T1,2,3 (T-1020)	All	40-106	30-106	APS164-03906	APS66-06800	16	APS177-01600

¹ Partial model eligibility

² Must verify wheel or brake assembly P/N

³ Use P/N APS66-06200 on the back plate and P/N APS66-06500 on the pressure plate.

⁴ OEM disc must be used

Eligibility continued on next page.



Brake and Wheel Parts Brake Discs and Linings



FAA-PMA Approved

Continued from previous page

Aircraft Model Piper	Serial Number	Wheel Assy P/N	Brake Assy P/N	Brake Disc P/N	Lining P/N	Linings per Wheel	Rivet or Pin P/N
PA-32-260	Heavy Duty Option	40-120	30-63	AOS164-21600	APS66-06200	4	APS177-00300
	32-1 thru 32-7300076	40-90	30-65	APS164-02201	APS66-10500	4	APS105-00200
	32-7400001 thru 32-7800008 ²	40-90	30-65	APS164-02201	APS66-10500	4	APS105-00200
		40-90A	30-65	APS164-02300	APS66-10500	4	APS105-00200
PA-32-300	Heavy Duty Option	40-120	30-83	APS164-21600	APS66-06200	4	APS177-00300
	32-40000 thru 32-7440000	40-90	30-65	APS164-02201	APS66-10500	4	APS105-00200
	32-7440001 thru 32-7940290 ²	40-90	30-65	APS164-02201	APS66-10500	4	APS105-00200
PA-32R-300, PA-32RT-300	Heavy Duty Option	40-120	30-83	APS164-21600	APS66-06200	4	APS177-00300
	All	40-90A	30-65	APS164-02300	APS66-10500	4	APS105-00200
PA-32RT-300T	Heavy Duty Option	40-120	30-83	APS164-21600	APS66-06200	4	APS177-00300
	32R-7887002 thru 32R-7987126	40-90A	30-65	APS164-02300	APS66-10500	4	APS105-00200
PA-32-301, PA-32-301T	Heavy Duty Option	40-120C	30-83A	APS164-21600	APS66-06200	4	APS177-00300
	All	40-90A	30-65	APS164-02300	APS66-10500	4	APS105-00200
PA-34-200	Heavy Duty Option	40-120	30-83	APS164-21600	APS66-06200	4	APS177-00300
	34-7250001 thru 34-7350353	40-90	30-65	APS164-02201	APS66-10500	4	APS105-00200
	34-7450001 thru 34-7450220 ²	40-90	30-65	APS164-02201	APS66-10500	4	APS105-00200
PA-34-200T	Heavy Duty Option	40-120	30-83	APS164-21600	APS66-06200	4	APS177-00300
	All	40-90A	30-65	APS164-02300	APS66-10500	4	APS105-00200
PA-34-220T	Heavy Duty Option	40-120	30-83A	APS164-21600	APS66-06200	4	APS177-00300
	All	40-90A	30-65	APS164-02300	APS66-10500	4	APS105-00200
PA-36-285, PA-36-300, PA-36-375	All	40-101	30-67B	APS164-03006	APS66-10800	4	APS105-00200
PA-38-112	All ²	40-78B	30-9B	APS164-01700	APS66-10600	2	APS105-00200
		40-59D	30-53A	APS164-06900	APS66-11200	2	APS105-00200
PA-39	All	40-90	30-23	APS164-02201	APS66-06500 ³	2	APS177-00300
					APS66-06200 ³	2	
PA-44-180	Heavy Duty Option	40-120	30-83	APS164-21600	APS66-06200	4	APS177-00300
	All	40-90A	30-65	APS164-02300	APS66-10500	4	APS105-00200
PA-44-180T	All	40-120	30-83	APS164-21600	APS66-06200	4	APS177-00300
PA-46-310P, 350P	All	40-120C	30-83A	APS164-21600	APS66-06200	4	APS177-00300
PA-60-600,601,601P,700P	All	40-124	30-88	APS164-05006	APS66-02200	8	APS177-00300
Pitts							
A-1	All	40-60	30-60	APS164-06700	APS66-10600	4	APS105-00200
S-1S,2	All	40-79B	30-9	APS164-01700	APS66-10600	2	APS105-00200
Quest Aircraft Design							
Kodiak 100	All	40-179	30-182	APS164-22201	APS66-03300 ⁵ APS66-15300 ⁵	8	APS177-00300
SAAB-Scania							
MF1-15, MF1-17	All	40-97D	30-63D	APS164-02601	APS66-10500	2	APS105-00200
Sadler Aircraft							
A-22 Lasa, 18-1000PV	All	40-78B	30-9	APS164-01700	APS66-10600	2	APS105-00200
Schleicher							
ASW21, 20, 22, 23 Sailplane	All	40-78B	30-9	APS164-01700	APS66-10600	2	APS105-00200
Shaefer Aircraft mods							
PA-31-350 Comanchero 500	All	40-195	30-158	APS164-21900	APS66-06800	12	APS177-01600
PA-31T Comanchero 750	All	40-106	30-106	APS164-03906	APS66-06800	16	APS177-01600
SIAI Marchetti							
SF.205	All	40-97E	30-63M	APS164-02601	APS66-10500	2	APS105-00200
SF.260, SF.260C	All	40-3	30-13	159-00200 ⁴	APS66-10500	4	APS105-00200
SF.260SW	All	40-90A	30-65A	APS164-02300	APS66-10500	4	APS105-00200
Slingsby Aviation							
T67M	All	40-86B	30-55	APS164-02000	APS66-10500	2	APS105-00200
Stinson							
108, 108-1,2,3,5	108-1 and up	40-28	30-18	APS164-00500	APS66-10600	2	APS105-00200
Stol Aircraft							
UC-1	All	40-74	30-51A	APS164-00700	APS66-10600	4	APS105-00200
Taylorcraft							
F-19, F-21, F-21A, F-22	All	40-86	32-55	APS164-02000	APS66-10500	2	APS105-00200
Univair							
A-2, A-2A	All	40-97A	30-63A	APS164-02601	APS66-10500	2	APS105-00200
Varga							
2150A, 2180	VAC-50 and up	40-97E	30-63E	APS164-02601	APS66-10500	2	APS105-00200
Waco							
Meteor, Minerva, Vela	All	40-97A	30-63A	APS164-02601	APS66-10500	2	APS105-00200
Weatherly Aviation							
201A, 201B, 201C	All	40-101	30-67D	APS164-03006	APS66-10800	4	APS105-00200
620, 620TP	1501 thru 1519	40-101	30-67D	APS164-03006	APS66-10800	4	APS105-00200
620A	1520 thru 1584	40-101	30-67D	APS164-03006	APS66-10800	4	APS105-00200
		40-101	30-89B	APS164-03006	APS66-10800	6	APS105-00200
620B	1550 and up	40-101		APS164-03006	APS66-10800	4	APS105-00200
	1520 and up	40-101 or 40-101E		APS164-03006	APS66-10800	6	APS105-00200
620TP	1520 thru 1584	40-101		APS164-03006	APS66-10800	6	APS105-00200
Wing Aircraft							
D-1	2 and up	40-84		APS164-01900	APS66-10600	4	APS105-00200

² Must verify wheel or brake assembly P/N

³ Use P/N APS66-06200 on the back plate and P/N APS66-06500 on the pressure plate.

⁴ OEM disc must be used

⁵ Aircraft with 30-182 calipers installed may use either APS66-03300 or APS66-15300 linings in complete sets. **Caution:** Never mix APS66-03300 linings on the same caliper as the APS66-15300's. APS66-15300 linings are .035" thicker than the APS66-03300's.

Brake and Wheel Parts



FAA-PMA Approved

APS BlackSteel® Brake Disc Dimensions

Table with columns: Brake Disc P/N, B (OD Wear), C (OD Base), D (Overall Height), E (Thickness Wear Surface), F (Number Bolt Holes), OEM Brake Manufacturer. Lists various brake disc models and their specifications.

Table with columns: Brake Disc P/N, B (OD Wear), C (OD Base), D (Overall Height), E (Thickness Wear Surface), F (Number Bolt Holes), OEM Brake Manufacturer. Lists various brake disc models and their specifications.

This is not a complete list of all brake discs offered. Please visit www.mcfarlaneaviation.com for additional dimensions.

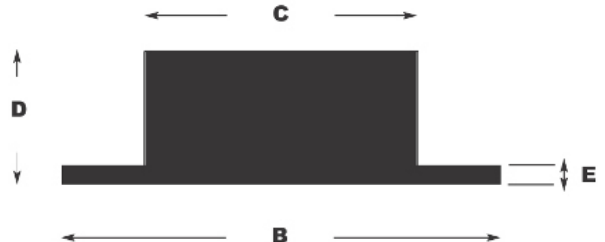

Brake Disc, Lining, and Rivet Eligibility for Aircraft with Cleveland Conversion Kits Installed (Includes Experimental Aircraft)

Table with columns: Aircraft Model, Cleveland Kit P/N, Wheel Assy P/N, Brake Assy P/N, Brake Disc P/N, Lining P/N, Linings per Wheel, Rivet or Pin P/N. Lists aircraft models and their compatibility with various conversion kits.

Eligibility continued on next page.



Brake and Wheel Parts Brake Discs and Linings



FAA-PMA Approved

Continued from previous page

Aircraft Model	Cleveland Kit P/N	Wheel Assy P/N	Brake Assy P/N	Brake Disc P/N	Lining P/N	Linings per Wheel	Rivet or Pin P/N
Cessna							
A185E,F ¹	199-60	40-75B	30-52	APS164-01501	APS66-10500	4	APS105-00200
	199-155	40-75J	30-52Y	APS164-03601	APS66-10500	4	APS105-00200
A185F ¹	199-62	40-75D	30-52N	APS164-03601	APS66-10500	4	APS105-00200
190, 195, 195A,B	199-61	40-40C	30-28C	APS164-00806	APS66-03300	6	APS177-00400
U206E,F, TU206E,F	199-60	40-75B	30-52	APS164-01501	APS66-10500	4	APS105-00200
	199-155	40-75J	30-52Y	APS164-03601	APS66-10500	4	APS105-00200
TU206E,F,G	199-62A	40-75T	30-52N	APS164-08300	APS66-10500	4	APS105-00200
U206E,F, TU206E,F	199-155	40-75J	30-52Y	APS164-03601	APS66-10500	4	APS105-00200
U206E,F, TU206E,F	199-62	40-75D	30-52N	APS164-03601	APS66-10500	4	APS105-00200
210,A,B,C,K,L,M, T210,K,L,M,N	199-60	40-75B	30-52	APS164-01501	APS66-10500	4	APS105-00200
P210N ²	199-60A	40-75B	30-52U	APS164-01501	APS66-10500	4	APS105-00200
310,310A,B,C,D,E,F,G,H,I,J,K,L,N,P,Q,R 310J-1, E310H,J, T310P,Q,R	199-64	40-40B	30-1	APS164-01406	APS66-03300	2	APS177-00400
340, 340A	199-76	40-135A	30-100	APS164-20306	APS66-06600	8	APS177-01600
340, 340A	199-72	N/A	30-100	APS164-06406	APS66-06600	8	APS177-01600
401,401A,B, 402,402A,B	199-76	40-135A	30-100	APS164-20306	APS66-06600	8	APS177-01600
	199-72	N/A	30-100	APS164-06406	APS66-06600	8	APS177-01600
402,402A,B,C	199-76	40-135A	30-100	APS164-20306	APS66-06600	8	APS177-01600
404	199-78	40-132	30-97	APS164-09100	APS66-06400	8	APS177-01600
411,411A, 414	199-72	N/A	30-100	APS164-06406	APS66-06600	8	APS177-01600
414,414A, 421,421A,B,C	199-76	40-135A	30-100	APS164-20306	APS66-06600	8	APS177-01600
441	199-115	40-169	30-143	APS164-20700	APS066-07300	6	APS177-01600
D.L.F. Holdings							
Tango	199-152	40-151	30-133	164-09900 ²	APS66-10500	2	APS105-00200
De Havilland							
Chipmunk DHC-1-21,22,22A, DHC-1B,-2, -S3,-S5	199-79	40-97D	30-63P	APS164-02601	APS66-10500	2	APS105-00200
Beaver DHC-2 MK 1,2,3	199-95	40-134	30-99	APS164-06306	APS66-06600	8	APS177-01600
Twin Otter DHC-6-1,100,200,300	199-92	40-21101	30-170	APS164-22400	APS66-10000	8	APS177-01600
Ercoupe							
415-C, CD, D, E, F-1, F-1A ³ , G	199-69	40-41	30-30	APS164-00300	APS66-10500	2	APS105-00200
Explorer Aeronautique							
Private Explorer Std	199-62	40-75D	30-52N	APS164-03601	APS66-10500	4	APS105-00200
Private Explorer Float	N/A	40-101	30-67B	APS164-03006	APS66-10800	4	APS105-00200
Express Aircraft							
Express 2000/2000RG	199-60	40-75B	30-52	APS164-01501	APS66-10500	4	APS105-00200
Four Winds Aircraft							
192/210/250T	199-60	40-75B	30-52	APS164-01501	APS66-10500	4	APS105-00200
Globe Swift							
GC1A, GC1B	199-48	40-113C	30-79B	APS164-04300	APS66-10500	2	APS105-00200
Gulfstream Aerospace							
500,A,B,S,U	199-122	40-198	30-159B	APS164-22000		8	APS177-01600
500,A,B,S,U	199-122A	40-198	30-159C	APS164-22000		8	APS177-01600
560F,680F, FL.FLP,T,V,W,681, 685, 690, 690A,B,C,D, 695,A,B	199-80	40-107A	30-107E	APS164-07200		8	APS177-01600
Hensely Aircraft							
F-19 Wolf Aerobatic	199-46	40-97A	30-63A	APS164-02601	APS66-10500	2	APS105-00200
F-19 Wolf Utility	199-62	40-75B	30-52	APS164-01501	APS66-10500	4	APS105-00200
Lancair							
IV High Energy, Energy Upgrade	199-224, 224A	40-406	30-233	APS164-02504	APS66-06200	4	APS177-00300
IV Standard	199-208	40-963	30-61E	APS164-02504	APS66-10500	4	APS105-00200
Legacy FG/RG	199-152	40-151	30-133	164-09900 ²	APS66-10500	2	APS105-00200
Murphy Manufacturing							
Rebel	199-71	40-60A	30-60A	APS164-06700	APS66-10600	4	APS105-00200
Navion							
A,B,D,E,F,G,H	199-52/199-52A	40-98D	30-66B	APS164-02707	APS66-11000	4	APS105-00200
Piper							
J3, PA-11,12,13,14,15,16,17,18,20	199-71A	40-97D	30-60A	APS164-02601	APS66-10600	4	APS105-00200
	199-71	40-60	30-60A	APS164-06700	APS66-10600	4	APS105-00200
PA-18A-150	199-71A	40-97D	30-60A	APS164-02601	APS66-10600	4	APS105-00200
	199-71	40-60	30-60A	APS164-06700	APS66-10600	4	APS105-00200
PA-31, -300,325,350	199-100	40-162	30-138	APS164-07700	APS66-06800	12	APS177-01600
PA-31-310,325,350	199-66	N/A	30-95A	APS164-07906	APS66-06600	8	APS177-01600
PA-31P (425 HP), PA31-350	199-83	40-141	30-123	APS164-07700	APS66-06800	12	APS177-01600
PA-31-350 ⁴	199-119	40-198	30-158	APS164-21900	APS66-06800	12	APS177-01600
PA-31T, PA-3T1	199-89	40-106	30-106	APS164-03906	APS66-06800	16	APS177-01600
PA-31T2	199-111	40-167	30-142	APS164-20600	APS066-07300	8	APS177-01600
PA-42, PA-42-720	199-112	40-166	30-141	APS164-07400	APS066-07300	8	APS177-01600
Pitts							
Pitts Special	199-103	40-78J	30-9C	APS164-01700	APS66-10600	2	APS105-00200
S1-S	199-102	40-78B	30-9	APS164-01700	APS66-10600	2	APS105-00200
RANS							
S-16	199-102	40-78B	30-9	APS164-01700	APS66-10600	2	APS105-00200
S-7C	199-104	40-59A	30-59A	APS164-07500 ⁵	APS66-11200	2	APS105-00200
Skystar Aircraft							
Kit Fox	199-215	40-281	30-224	164-23400 ²	APS66-10500	2	N/A
Pulsar	199-102	40-78B	30-9	N/A	APS66-10600	2	APS105-00200
Steen Aero Lab							
Skybolt	199-104	40-59A	30-59A	APS164-07500 ⁵	APS66-11200	2	APS105-00200
	199-105	40-113X	30-75X	APS164-04000	APS66-10500	2	APS105-00200
Swift							
GC-1A, GC-1B	199-98	40-113C	30-79B	APS164-04300	APS66-10500	2	APS105-00200
Univair							
108 Series	188-87	40-97D	30-63Q	APS164-02601	APS66-10500	2	APS105-00200
Van's Aircraft							
RV-3, RV-9	199-102	40-75B	30-9	APS164-01700	APS66-10600	2	APS105-00200
RV-10	199-104	40-59A	30-59A	APS164-07500 ⁵	APS66-11200	2	APS105-00200
Velocity Aircraft							
SE/XL	199-60	40-75B	30-52	APS164-01501	APS66-10600	4	APS105-00200

¹ Partial model eligibility
² OEM brake disc or lining must be used, this part is not FAA-PMA approved.
³ This part is not FAA-PMA approved
⁴ Modified by Schaefer STC SA678SW
⁵ S/N 813 and on



APS BlackSteel® Brakes for Pilatus PC-12

Cost effective replacement brake parts for the PC-12 with Cleveland Brakes

- All parts are FAA-PMA approved
- Longer wear life
- Parts are offered individually or as a convenient brake overhaul kit

New!

Brake and Wheel Parts

Brake Overhaul Kit P/N APS199-575A			
Kit Includes P/N	Description	Qty	Index
APS095-01100	Washer-seal	1	1
APS101-00700	O-ring	2	2
APS101-02500	O-ring	6	3
APS105-02401	Rivet	48	4
APS105-08701	Rivet	48	5
APS107-03700	Scraper	6	6
APS109-03000	Wear Pad	72	7
APS159-07400	Rotor Assembly	3	8

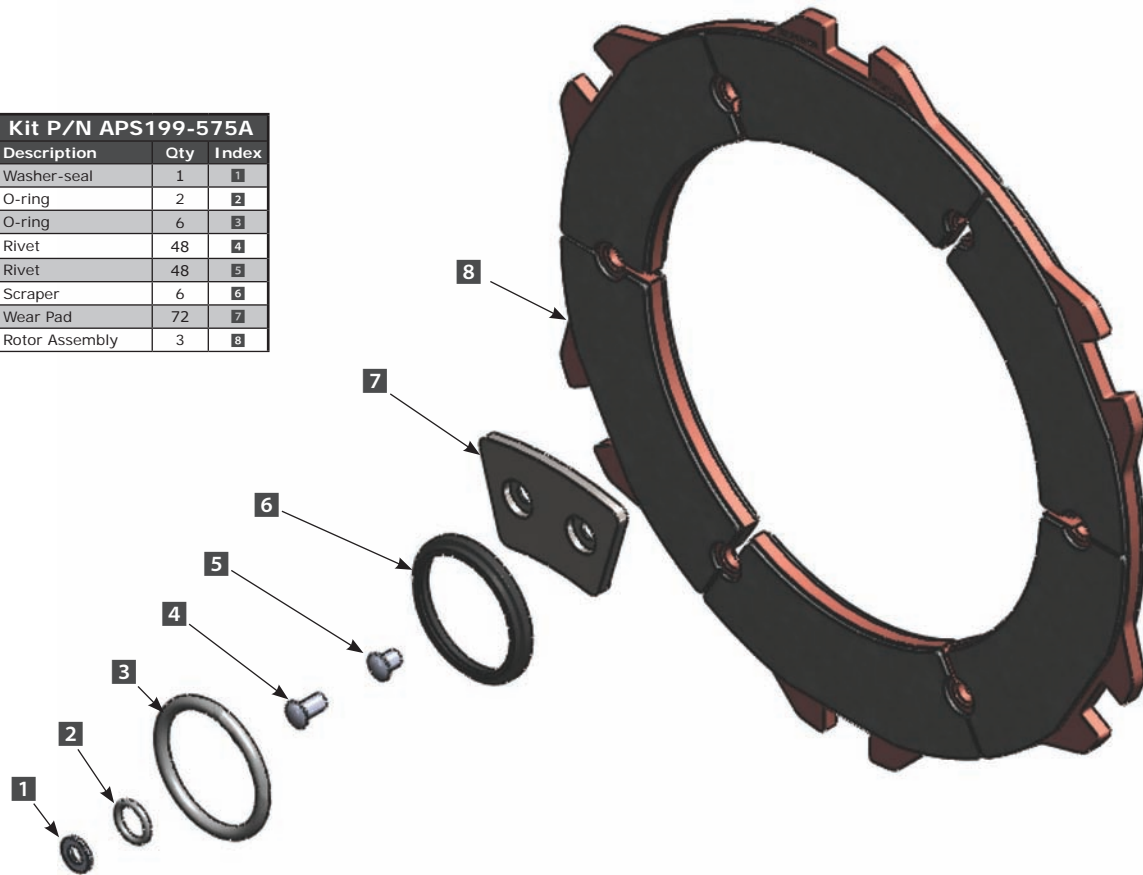

APS Blacksteel Brakes for Caravan Aircraft

Improve braking performance!

- One piece forged disc eliminates weld failure
- Heat treated to reduce corrosion & rust
- FAA-PMA Approved



APS Extended Life Brake Lining

Reduce cost per landing

- Lining is .035" thicker
- 35% longer life!
- FAA-PMA Approved

Complete Brake Kit

P/N APS164-22201-1 contains:

2 brake discs P/N APS164-22201,

16 brake linings P/N APS66-15300

32 pins P/N APS177-00300



McFarlane Aircraft Tire Balancers

Tire balance is important.

Now it's fast, accurate and affordable!

Aircraft tires spin 1.6 times faster than car tires. Out-of-balance tires cause a long list of maintenance problems:

- Uneven tire wear
- Premature bearing wear
- Shimmy and resulting torque link damage
- Destructive and distracting airframe vibration

McFarlane's tire balancer is a suspension tire balancer with a patented design featuring a pivot point that is easily adjustable on-the-fly for maximum balance sensitivity. It is small enough to fit in a tool box and doesn't require a bulky stand. The McFarlane design is more precise than other static balancing methods, and allows the wheel and tire to be balanced with the bearings and seals installed.

It's fast and easy. Due to the horizontal balancing orientation, test weights can be temporarily set in place and easily adjusted while balancing. This eliminates the need to tape the test weights. The McFarlane tire balancers are precision machined with a black, hard anodized finish, and comes in an oiled wooden case. This is a **lifetime tool** that fits almost all light aircraft wheel/tire assemblies.

- On-the-fly adjustable pivot point for maximum sensitivity (U.S. Patent No. US 9,032,793 B1)
- Portable – small enough to fit in your toolbox
- Does not require removal of bearings or seals
- Complete instructions included
- Multiple models and add-on bushing kits to accommodate 3/4", 1", 1 1/4", 1 1/2", 1 3/4" and 2" axles
- Conveniently packaged in a durable wooden box
- Doubles as a propeller balancer when used with our optional bushings

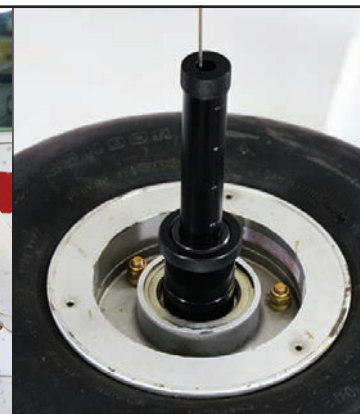

**New and Improved
More Axle Sizes!**

Part Number	Description
TOOL128	Tire balancer for 3/4" diameter axles (common on experimental aircraft)
TOOL129 (Supersedes TOOL108)	Tire balancer for 1", 1 1/4", and 1 1/2" axles, including Cessna 300 and 400 Series tapered axles with 1 1/2" and 1" bearing bores.
TOOL129 LA-KT	Large Axle Bushing Kit for 1 1/4" and 2" axles (compatible with TOOL129 only)
TOOL108 LA-KT	Large Axle Bushing Kit for 1 1/2" and 2" axles (compatible with TOOL108 only)



P/N TOOL129 LA-KT



P/N TOOL129



Costs less and more accurate than axle style balancers.
Now available to accommodate standard and taper axle sizes ranging from 3/4" to 2".

FAA-PMA Approved

Brake Bleeder Valves for Cleveland and McCauley Wheels
Improved - No more rust, no more rounded wrench flats

Save \$\$

Bleeder Screw

- Strong heat treated 17-4 stainless steel prevents corrosion and rounding of the hex
- Increased hex size further resists rounding of the wrench hex

Bleeder Seat

- Stainless steel for corrosion resistance
- Type III class 3 cadmium plating sure is ugly, but it's the best protection against galvanic corrosion with the magnesium housing.

Even the Rubber Cap is Improved!

- Improved material prevents cracking
- Shorter design results in a more secure fit

Convenient Kits

- Two kits required per aircraft
- Components also available separately



Brake and Wheel Parts

MCBB-KT-1		
Qty	Part Number	Description
1	MC081-00100	Bleeder Seat
1	MC079-00300	Bleeder Screw
1	MC183-00100	Needle Cap

MCBB-KT-2		
Qty	Part Number	Description
1	MC081-00200	Bleeder Seat
1	MC079-00300	Bleeder Screw
1	MC183-00100	Needle Cap
1	MS28775-012	O-ring

MCBB-KT-3		
Qty	Part Number	Description
1	MC081-00500	Bleeder Seat
1	MC079-00300	Bleeder Screw
1	MC183-00100	Needle Cap
1	MS28775-011	O-ring

MCBB-KT-4		
Qty	Part Number	Description
1	MC081-00600	Bleeder Seat
1	MC079-00300	Bleeder Screw
1	MC183-00100	Needle Cap
1	NAS1612-4A	O-ring

MCBB-KT-5		
Qty	Part Number	Description
1	MC081-30169	Bleeder Seat
1	MC079-00300	Bleeder Screw
1	MC183-00100	Needle Cap
1	MS28775-011	O-ring

FAA-PMA Direct Replacements

Currently approved for most Cessna

Description	McFarlane P/N	Cleveland P/N	Cessna P/N	McCauley P/N
Bleeder Seat	MC081-00100	081-00100	37-206	A30030
Bleeder Screw	MC079-00300	079-00300	FC6446	A30085
Bleeder Seat	MC081-30169	081-30169		A30169
Needle Cap	MC183-00100	183-00100		A30040
Needle Cap	MC183-00100	183-1		A30040
Needle Cap	MC183-00100	183-0100		A30040

Aircraft	Serial Number	When equipped with brake number or Cleveland conversion kit:	Part Number
120, 140, 140A	All	Only for use with Cleveland conversion kit 199-46	MCBB-KT-1
150A,B,C,D,E,F,G,H,J,K,L,M	All		MCBB-KT-1
A150K,L,M	All		MCBB-KT-1
F150F,G,H,J,K,L,M	All		MCBB-KT-1
FA150K,L,M	All		MCBB-KT-1
152	15279406 thru 15285161	C163032-0110 or C163030-0113 (30-75)	MCBB-KT-1
	15285162 thru 15286033	C163033-0101 (C30018)	MCBB-KT-5
A152	All	C163032-0110 or C163030-0113 (30-75)	MCBB-KT-1
	A1520984 thru A1521049	C163033-0101 (C30018)	MCBB-KT-5
F152, FA152	All		MCBB-KT-1
170, 170A,B	All	Only for use with Cleveland conversion kit 199-46, 199-62, or 199-62A	MCBB-KT-1
172, 172A,B,C,D,E	All	Only for use with Cleveland conversion kit 199-46, 199-62, or 199-62A	MCBB-KT-1
172F,G,H,I,K,L,M,N	All		MCBB-KT-1
172P	17274010 thru 17275034	C163030-0111 (30-75A), C163032-0105, C163032-0113 (C30018-6) or equipped with Cleveland conversion kit 199-62, or 199-62A	MCBB-KT-1
	17275035 thru 17275868	C163033-0102 (C30764-6)	MCBB-KT-5
172Q	All	Only for use with Cleveland conversion kit 199-62, or 199-62A	MCBB-KT-1
172R,S	All		MCBB-KT-5
172R	172RG0001 thru 172RG0890		MCBB-KT-1
	172RG0891 thru 172RG1191		MCBB-KT-5
F172D,E,F,G,H,K,L,M,N,P	All		MCBB-KT-1
FR172E,F,G,H,J,K, R172E,F,G,H,K	All		MCBB-KT-1
P172D	All	Only for use with Cleveland conversion kit 199-46	MCBB-KT-1
175, 175A,B,C	All	Only for use with Cleveland conversion kit 199-46, 199-62, or 199-62A	MCBB-KT-1
177, 177A,B, 177RG, F177RG	All		MCBB-KT-1
180	All	Only for use with Cleveland conversion kit 199-46, 199-60, 199-62 or 199-62A	MCBB-KT-1
180A,B,C,D,E,F	All	Only for use with Cleveland conversion kit 199-46, 199-60, or 199-62	MCBB-KT-1
180G,H	All		MCBB-KT-1

Continued on next page

Brake and Wheel Parts



MCBB-KT-1



MCBB-KT-2



MCBB-KT-3



MCBB-KT-4



MCBB-KT-5

Continued from previous page			
Aircraft	Begin Serial	When equipped with brake number or Cleveland conversion kit:	Part Number
180J	18052285 thru 18052384	1241157-1, C163030-0303 (30-52), C163030-0305 (30-52D), or C163030-0113 (30-75) or equipped with Cleveland conversion kit 199-60	MCBB-KT-1
	18052385 thru 18052770	C163030-0303 (30-52) or C163030-0113 (30-75) or equipped with Cleveland conversion kit 199-62	MCBB-KT-1
	All	C163032-0205 (30-52U), C163032-0206 (D30118-4), C163032-0207 (D30118-5), or C163032-0208 (D30118-6)	MCBB-KT-5
180K	All	C163030-0303 (30-52) or C163030-0113 (30-75) or equipped with Cleveland conversion kit 199-62	MCBB-KT-1
182	All	C163032-0205 (30-52U), C163032-0206 (D30118-4), C163032-0207 (D30118-5), or C163032-0208 (D30118-6)	MCBB-KT-5
182A,B,C,D,E,F,G	All	Only for use with Cleveland conversion kit 199-46	MCBB-KT-1
182H,J,K,L,M,N,P,Q	All	Only for use with Cleveland conversion kit 199-46, 199-62, or 199-62A	MCBB-KT-1
182R	All		MCBB-KT-5
182S	All	Only for use with Cleveland conversion kit 199-62, or 199-62A	MCBB-KT-1
182T, T182T	All		MCBB-KT-3
A182J,K,L,N	All		MCBB-KT-1
F182P,Q	All		MCBB-KT-1
FR182	All		MCBB-KT-5
R182, T182, TR182	All		MCBB-KT-5
185, 185A,B,C,D,E, A185E	All		MCBB-KT-1
A185F	18502091 thru 18502300	C163032-0205 (30-52U), C163032-0206 (D30118-4), C163032-0207 (D30118-5), or C163032-0208 (D30118-6)	MCBB-KT-5
	18502091 thru 18502310	1241157-1, C163030-0303 (30-52), C163030-0305 (30-52D), or C163030-0113 (30-75) or when equipped with Cleveland conversion kit 199-60 or 199-62	MCBB-KT-1
	18502311 thru 18504448	C163030-0303 (30-52) or C163030-0113 (30-75)	MCBB-KT-1
188, 188A,B, A188, A188A,B, A188B	18800001 thru 18802348	C163030-0301 (30-52B) or C163030-0302 (30-52B)	MCBB-KT-1
188, 188A,B, A188, A188A,B	18800001 thru 18802348	30-67A, C163030-0601 (30-67C), C163030-0503 (30-66A), or C163030-504 (30-66A)	MCBB-KT-2
A188B	18802349 thru 18803973		MCBB-KT-2
A188B (w/large hopper)	18800833T thru 18802348T	C163030-0301 (30-52B) or C163030-0302 (30-52B)	MCBB-KT-1
	18800833T thru 18802348T	30-67A, C163030-0601 (30-67C), C163030-0503 (30-66A), or C163030-504 (30-66A)	MCBB-KT-2
	18802349T thru 18803973T		MCBB-KT-2
T188C	All		MCBB-KT-2
190, 195, 195A,B	All	Only for use with Cleveland conversion kit 199-61	MCBB-KT-2
210-5 (205), 210-5A (205A)	All		MCBB-KT-1
206, 206H	All		MCBB-KT-1
P206, P206A,B,C,D,E	All		MCBB-KT-1
T206H	All		MCBB-KT-1
TP206A,B,C,D,E, TU206A,B,C,D,E	All		MCBB-KT-1
TU206F, U206F	U20601701 thru U20602199		MCBB-KT-1
TU206F,G, U206F,G	U20602200 thru U20607020	C163030-0303 (30-52) or C163030-0313 (30-52N) or when equipped with Cleveland conversion kit 199-62	MCBB-KT-1
	All	C163032-0205 (30-52U), C163032-0206 (D30118-4), C163032-0207 (D30118-5), or C163032-0208 (D30118-6)	MCBB-KT-5
U206, U206A,B,C,D,E	All		MCBB-KT-1
207, 207A, T207, T207A	All		MCBB-KT-1
208, 208A,B	All		MCBB-KT-3
210, 210A,B	All	Only for use with Cleveland conversion kit 199-60	MCBB-KT-1
210C,D,E,F,G,H,J,K	All		MCBB-KT-1
210L,M	All	C163030-0303 (30-52) or when equipped with Cleveland conversion kit 199-60	MCBB-KT-1
	21060090 thru 21062954	C163032-205 (30-52U) or C163032-206 (D30118-4)	MCBB-KT-5
210N	21062955 thru 21063114	121494-3 or 121494-4	MCBB-KT-2
	21063115 thru 21064135	C163030-0315 (30-52V), C163030-0316 (30-52V), 30-05220, or 30-05270	MCBB-KT-3
	21064136 thru 21065009		MCBB-KT-3
	All	C163032-209 or C163032-210	MCBB-KT-5
210R, T210R	All		MCBB-KT-3
P210N	P21000001 thru P21000150	C163032-205 (30-52U) or C163032-206 (D30118-4)	MCBB-KT-5
	P21000151 thru P21000191	121494-3 or 121494-4	MCBB-KT-2
	All	Only for use with Cleveland conversion kit 199-60	MCBB-KT-1
P210R	All	C163030-0315 (30-52V) or C163030-0316 (30-52V) or when equipped with Cleveland conversion kit 199-60A	MCBB-KT-3
T210F,G,H,J,K	All	C163030-0901 (30-127) or C163030-0902 (30-127)	MCBB-KT-3
T210L,M	All		MCBB-KT-1
	21060090 thru 21062954	C163030-0303 (30-52) or when equipped with Cleveland conversion kit 199-60	MCBB-KT-1
T210N	21062955 thru 21063114	C163032-205 (30-52U) or C163032-206 (D30118-4)	MCBB-KT-5
	21063115 thru 21064135	121494-3 or 121494-4	MCBB-KT-2
	21064136 thru 21065009	C163030-0315 (30-52V), C163030-0316 (30-52V), 30-05220, or 30-05270	MCBB-KT-3
	All	C163032-209 or C163032-210	MCBB-KT-3
310, 310B,C,D,F,G,H,I,J,J-1,K,L,N,P,Q	All	Only for use with Cleveland conversion kit 199-64	MCBB-KT-2
E310H,J	All	Only for use with Cleveland conversion kit 199-64	MCBB-KT-2
T310P,Q	All	Only for use with Cleveland conversion kit 199-64	MCBB-KT-2
320, 320-1, 320A,B,C,D,E,F	All	Only for use with Cleveland conversion kit 199-64	MCBB-KT-2
336	All		MCBB-KT-1
337E,F, F337E,F, FT337E,F, T337E,F	All		MCBB-KT-1
310R, T310R	All		MCBB-KT-2
335	All		MCBB-KT-2
340, 340A	All		MCBB-KT-2
401, 401A,B	All	Only for use with Cleveland conversion kit 199-72 or 199-76	MCBB-KT-2
402, 402A,B	All	Only for use with Cleveland conversion kit 199-72 or 199-76	MCBB-KT-2
402C	All		MCBB-KT-2
404	All	Only for use with Cleveland conversion kit 199-78	MCBB-KT-2
411, 411A	All		MCBB-KT-2
414, 414A	All		MCBB-KT-2
421	All	Only for use with Cleveland conversion kit 199-76	MCBB-KT-2
421C	All		MCBB-KT-2
441	All	Only for use with Cleveland conversion kit 199-115	MCBB-KT-2
500, 501	All	91891-003 (030-18902 formerly 30-189B) or when equipped with Cleveland conversion kit 199-60	MCBB-KT-4
550, 551	All	030-18902 formerly 30-189B or when equipped with Cleveland conversion kit 199-60	MCBB-KT-4
S550	All	Only for use with Cleveland conversion kit 199-177	MCBB-KT-4

Brake and Wheel Parts

Brake Assembly and Master Cylinder Seal Kits for Cessna Aircraft

Save time and \$\$ with kits containing just the parts you need!

McFarlane has done the research so you don't have to. Now buy one kit per brake assembly or master cylinder and get the right seals for the job without wasting money on expensive parts you don't need.

All parts are standard hardware or Cessna original parts with 8130-3 tags.

Six new kits to replace TCBMD

- Expanded eligibility (188 thru 210, 337 and Caravan models)
- McFarlane original kit
- One kit required per brake assembly or master cylinder
- Approved parts

Save \$\$

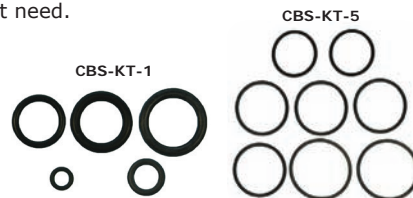

Aircraft Model	Serial Number	Master Cylinder Seal Kits				Brake Assembly Seal Kits	
		CBS-KT-1	CBS-KT-2	CBS-KT-3	CBS-KT-4	CBS-KT-5	CBS-KT-6
120, 140	All						
150, 150A,B,C,D,E,F,G,H,J,K,L,M	All	*				*	*
F150F,G,H,J,K,L,M, FA150K,L,M, FRA150L,M	All	*				*	*
A-150L, A-A150L, A150K,L,M	All	*				*	*
152, A152, F152,FA152	All	*				*	*
170, 170A	All				*	*	*
170B	All	*				*	*
172, 172A,B,C,D,E,F,G,H,I,K,L,M,N	28000 thru 17271034	*				*	*
172N,P,Q	17271035 and On	*	*			*	*
F172D,E,F,G,H,K,L,M,N	F172-0001 thru F17201749	*	*			*	*
F172N,P	F17201750 thru F17202254	*	*			*	*
R172K	R1722000 thru R1722929	*	*			*	*
FR172E,F,G,H,J	R1722930 thru R1723454	*	*			*	*
FR172K	All	*	*			*	*
FR172K	FR17200591 thru FR17200630	*	*			*	*
FR172K	FR17200631 thru FR17200675	*	*			*	*
R172E,F,G,H	All	*	*			*	*
175, 175A,B,C	All	*	*			*	*
177, 177A,B	All	*	*			*	*
177RG	All	*	*			*	*
180, 180A,B,C,D,E,F,G,H,J,K	30000 thru 18053000	*	*			*	*
180K	18053001 and On	*	*			*	*
182, 182A,B,C,D,E,F,G,H,J,K,L,M,N,P,Q	33000 thru 18266590	*	*			*	*
182Q,R,S,T	18266591 and On	*	*			*	*
F182P,Q	F18200001 thru F18200094	*	*			*	*
F182Q	F18200095 and On	*	*			*	*
FR182	FR18200001 thru FR18200020	*	*			*	*
FR182	FR18200021 thru FR18000070	*	*			*	*
T182, T182T, TR182	All	*	*			*	*
185, 185A,B,C,D,E, A185E,F	185-0001 thru 18503683	*	*			*	*
A185F	18503684 and On	*	*			*	*
188, 188A,B, A188, A188A,B	188-0001 thru 18803296	*	*			*	*
A188B	18803297 and On	*	*			*	*
A188B (w/ large hopper)	18800833T thru 18803296T	*	*			*	*
A188B (w/ large hopper)	18803297T and On	*	*			*	*
206, U206, U206A,B,C,D,E,F,G, TU206A,B,C,D,E,F,G	All	*	*			*	*
P206, P206A,B,C,D,E, TP206A,B,C,D,E	All	*	*			*	*
206H, T2006H	All	*	*			*	*
208, 208B	All	*	*			*	*
210, 210A,B	All	*	*			*	*
210C,D,E,F,G,H,J,K,L,M, T210F,G,H,J,K,L,M	All	*	*			*	*
210N,R, T210N,R	All	*	*			*	*
337, 337A,B,C,D,E,F,G,H	337-0002 thru 33701874	*	*			*	*
337H	33701875 and On	*	*			*	*
T337B,C,D	All	*	*			*	*

- 1 Partial model eligibility
- 2 Use this kit when NOT equipped with master cylinder assembly P/N 9882010-1
- 3 Use this kit when equipped with master cylinder assembly P/N 9882010-1

Kit P/N	Kit Type	Qty	Component P/N	Description
CBS-KT-1	Master Cylinder Seal Kit	1	MS28775-110	O-ring
		1	MS28775-111	O-ring
		1	MS28775-009	O-ring
		1	MS28778-4	O-ring
		1	800-001-6	Lock-O-Seal
CBS-KT-2	Master Cylinder Seal Kit	1	MS28775-110	O-ring
		1	S1628-110	Backup Ring
CBS-KT-3	Master Cylinder Seal Kit	1	MS28775-112	O-ring
		1	MS28775-110	O-ring
		1	MS28775-016	O-ring
		1	S1628-110	Backup Ring
CBS-KT-4	Master Cylinder Seal Kit	1	600-0115-6	Stat-O-Seal
		1	MS28775-012	O-ring
CBS-KT-5	Brake Assembly Seal Kit	2	MS28775-224	O-ring
		2	MS28775-218	O-ring
		4	MS28775-222	O-ring
CBS-KT-6	Brake Assembly Seal Kit	1	MS28775-225	O-ring
		1	MS28775-327	O-ring
		1	MS28775-224	O-ring
CBS-KT-6	Brake Assembly Seal Kit	1	MS28775-222	O-ring



P/N TCBMD supersedes to CBS-KT-1 thru CBS-KT-6. See eligibility to determine the required kit.

Brake assembly and master cylinder seal kits for Caravan brakes.
See complete Caravan section on pages 247-256

